

HSM2HOST双向无线收发器

V1.1安装手册



警告：本手册含产品使用和功能的限制条件信息以及有关制造商义务的限制条件信息。请仔细阅读整个手册。

目录

规格和功能的无线设备	3
兼容性的说明	3
安全介绍	5
控制指示灯	6
状态指示灯	6
安装	6
连接HSM2HOST	7
注册HSM2HOST	7
从系统中移除HSM2HOST;	7
永久安装无线设备	7
无线设备安装和设置	8
[804][000]注册无线设备	8
[804][001]-[716]无线设备配置	8
[804][801]射频阻塞检测	8
[804][802]无线监控窗口	9
[804][810]无线选项!	9
[804][841]运动摄像头	9
[804][901]-[905]删除无线设备	10
[804][921]-[925]更换无线设备	10
[804][990][001-005]显示默认值	10
[804][999]复位成的工厂默认值	11
[904]无线设备的位置测试	11
设置工作表	12
[000]模块标签	12
[804][000]无线设备注册 - 无线钥匙器	15
[804][000]无线设备注册 - 无线钥匙器	15
[804][000]无线设备注册 - 无线钥匙器	16
[804][000]无线设备注册 - 无线钥匙器	16

规格和功能

- 电流消耗: 60mA
 - 电压: 消耗电力来自于 PowerSeries Neo 报警控制器 (10.8VDC 至 12.5VDC) - 有限电源
 - </sup>
 - 防区 - 可接收高达128个无线防区的信号, 外加16个无线键盘的信号。还支持最多32位无线钥匙或32个应急链和16个报警器
 - 监控 - 可编程监控窗口
 - 从带有 22 AWG 线的主机的布线长度达 1000 英尺 / 230 米
 - 连接 Corbus
 - 兼容性: HSM2HOST与 PowerSeries Neo 报警主机一起使用
 - 工作温度: 0°C至 +49°C (32-122°F)
 - 相对湿度: 93%, 无冷凝
 - 单独、内置墙壁和外壳防拆
- 注意:** 对于商用盗警 UL, 监控窗口应设置为 4 小时。
对于住宅火警 UL/ULC, 监控窗口应设置为 200 秒。
对于住宅盗警 UL/ULC, 监控窗口应设置为 24 小时。
对于 UL 家庭保健应用, 监控窗口应设置为 24 小时。
在注明处, 仅在频带 912-919MHz 操作的型号为 UL/ULC 认证型。仅 UL 批准的设备可与 UL/ULC 认证系统一起使用。

兼容的无线设备

HSM2HOSTx (x= 4/8/9)可接收来自于以下图表中所列设备的信号。如需了解操作说明书, 请参见设备说明书。在本文中, 型号中的x代表设备的工作频率, 如9 (912-919 MHz)、8 (868MHz)和4 (433MHz)。

报警控制器	
PowerSeriesNeo报警控制器	HS2128HS2064 HS2032HS2016
模块	
无线键盘	HS2LCDWFx HS2LCDWFPx HS2LCDWFPVx
无线设备	
无线 PG 烟感器	PGx926UL
无线 PG 烟雾和热探测器	PGx916UL
无线 PG 一氧化碳探测器	PGx913
无线 PG PIR 运动探测器	PGx904(P)UL
无线 PG PIR+摄像头运动探测器	PGx934(P)UL
无线户外 PG PIR+摄像头运动探测器	PGx944
无线 PG 幕帘式运动探测器	PGx924UL
无线 PG 双技术运动探测器	PGx984(P)
无线 PG 反射镜运动探测器	PGx974(P)UL
无线 PG 户外运动探测器	PGx994UL
无线 PG 玻璃破碎探测器	PGx912
无线 PG 冲击探测器	PGx935UL
无线 PG 水灾探测器	PGx985UL
无线 PG 温度探测器 室内使用	PGx905UL
无线 PG 键	PGx939UL
无线 PG 键	PGx929UL
无线 PG 应急键	PGx938UL
无线 PG 2按钮键	PGx949UL
无线 PG 室内报警器	PGx901UL
无线 PG 户外报警器	PGx911UL
无线 PG 中继器	PGx920UL
无线 PG 门/窗接触器	PGx975UL
无线 PG 门/窗接触器,带辅助装置	PGx945UL

安全说明

- 该设备必须由服务人员进行安装。服务人员的定义为：获得相应的技术培训和经验，清楚在执行任务时可能遇到哪些危险，知道应该采取哪些措施将自己或他人面临的风险最小化的人员。它必须在这样一个环境下安装和使用，即最大污染等级2，过电压类别二，无危害的室内地点进行。
- 切勿尝试自己修理产品。盖子的开启或移除作业可能使得用户暴露于危险的电压或其他风险之中。任何维护作业应由专业维护人员进行。
- 本设备仅使用授权附件。
- 报警控制器加电之前将变送器固定在建筑构件上。

只有UL/ULC认证的设备可以在UL/ULC用于上市的安装。

HSM2HOST9针对 UL 商用盗警、住宅火警、住宅盗警和家庭卫生保健、ULC 住宅火警和住宅盗警进行了认证：

UL1610接警中心 警单元

UL1023家庭盗警系统单元

UL985 家庭火警系统单元

UL1637 家庭保健信号设备

ULC-S545-02住宅火警系统控制单元

ORD-C1023-1974 家庭盗警系统单元

UL 609 本地盗警单元和系统

UL365 连接盗警单元和系统的警察局

介绍

该HSM2HOSTx双向无线收发增加无线能力PowerSeries理学报警控制器，型号HS2128，HS2064，HS2032和HS2016。该HSM2HOST接收来自无线区域和无线密钥，并提供信息给报警控制器它连接到。本手册描述了如何安装、设置和维护HSM2HOST。注意，报警系统中只能注册一个HSM2HOST或RFK键盘。

控制和指示灯

状态指示灯

HSM2HOST前面的指示灯提供有关单元安装、操作和故障排除的反馈信息。指示灯功能如下：

红色指示灯	操作
模块加电：	模块加电顺序过程中指示灯稳定发亮，随后熄灭。
固件更新：	缓慢闪烁 = 更新进行中 快速闪烁 = 更新失败
故障条件：	<ul style="list-style-type: none">• 无故障：每 10 秒快速闪烁 1 次。• 无故障：每 10 秒快速闪烁 1 次。• 1次闪烁：模块未注册• 2次闪烁：与模块失去联系超过 60 秒• 3次闪烁：Corbus电压低• 8次闪烁：射频干扰 阻塞情况
模块确认：	模块确认流程期间快速闪烁。
位置测试：	模块确认流程期间快速闪烁。
绿色指示灯	操作
位置测试：	操作 注意： 位置测试：

防拆

对于获得 UL/ULC 认证的系统，信号必须足够“强”。请参见第10页“无线设备状态指示”，了解详细信息。

防拆

HSM2HOST具有单独的内置壁挂和外壳防拆功能。在 NA 版本中，外壳防拆默认禁用。在 EU 版本中启用。

注意：对于 UL/ULC 认证的商业/住宅盗警应用，必须安装和启用内置式壁挂和外壳防拆设备。

安装

注意：永久安装HSM2HOST接收器和放置后的无线设备测试每个设备。

寻找符合下列要求的位置：

- 干燥；
- 在工作温度范围内；
- 位于所有无线设备的建议位置的中心；
- 要尽可能高。如果安装在地表下方，高度应相适当减少；
- 远离干扰源，包括：电噪音 计算机、电视、电机、电器、加热和空调设备，以及

- 可能屏蔽电磁波的大型金属物体，如暖气管和管道系统；
- 到装置后方的通道应顺畅、无阻碍。

连接HSM2HOST

警告：在将模块连接到 *Corbus* 上时，应拆走系统的所有电源（交流电、直流电和电话线）。

要连接 HSM2HOST：

1. 断开报警主机电源后，按照图 1 将 HSM2HOST 连接到报警主机的四线 *Corbus* 上。
2. 完成布线后，启动安全系统。

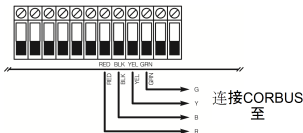

：图 1 布线图

注册HSM2HOST

必须先将 HSM2HOST 注册到报警主机中，然后才能注册任何其他无线设备。当报警系统第一次通电时，就可以注册第一个键盘或 HSM2HOST。如果使用无线键盘作为第一键盘。

采用以下方法：

1. 一旦 HSM2HOST 与报警主机连线并已接通电源，则接通了无线键盘电源。
2. 按键盘上的任何按键，在 HSM2HOST 上注册它。然后在报警主机上自动注册 HSM2HOST。

或任何时候通过下列步骤在系统上对 HSM2HOST 进行注册：

1. 进入安装程序第 [902] [000] 自动报名参加所有模块。模块按以下顺序自动检测：
2. 出现提示后，按 [*] 进行注册。

要从系统中移除HSM2HOST：

输入安装人员设置段 [902] [106] 删除 HSM2HOSTx。

1. 输入安装程序设置段 [902] [106] (删除 HSM2HOSTx)。
2. 按 [*] 进行删除。

永久安装

找到合适的安装位置后，按以下步骤安装 HSM2HOST：

1. 穿过机柜后方的孔拉 *Corbus* 电线。
2. 使用提供的三颗螺钉，将机柜安全固定到墙上。
3. 如要启用壁挂式防拆装置，应使用提供的螺钉，将断开式壁挂防拆装置支架安全固定到墙上。



图 2 安装 HSM2HOST

无线设备安装和设置

[804][000] 注册无线设备

1. 输入安装人员设置段 [804][000]。
2. 得到提示后,可以激活该设备(参见设备安装表)立即注册或输入设备 ID 号。输入设备 ID 号对设备进行预注册,稍后再在客户站点注册它们。报警主机决定要注册的设备类型,并显示合适的设置选项。
3. 使用滚动键或输入对应号码选择选项。
4. 滚动现有的选项,键入一个编号;或如果合适的话,输入文本。
5. 按 [*] 接受,并移动至下一个选项。
6. 一旦配置所有选项,系统就会提示您注册下一个设备。
7. 重复上述过程,直到所有无线设备注册完毕。

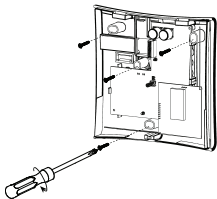
[804]-[001]-[716] 无线设备配置

如要配置无线设备:

1. 输入安装人员设置段 [804], 然后选择下面其中一个子段:
 - 001-128- 配置无线防区
 - 551-566- 配置无线报警器
 - 601-632- 配置无线钥匙
 - 701-716- 配置无线键盘
2. 使用滚动键选择要配置的设备,或输入热键直接进入特定设备。
3. 如需了解详细信息,请参见设备表。按 [*] 接受,移动至下一个选项。
4. 一旦所有选项配置完毕后,系统便返回基础配置菜单。
5. 如需配置其他无线设备,请重复上述过程。
6. Repeat the process described above to configure other wireless devices.

[804][801] 射频阻塞检测

要配置射频阻塞:

1. 输入安装人员设置段 [804][801], 然后选择下面其中一个选项:
 - 00-禁用
 - 01-UL20/20-美国

- 02-EN 30/60-欧洲
 - 03-第6类 30/60-英国
2. 按 [*] 接受该选择。
 3. 按 [#] 键, 退出该段。

[804][802] 无线监控窗口

对于 EN 安装, 必须选择1个或2个小时。
使用选项 06 时, 也就是配置设备被检测到消失 24 小时后系统生成错误的选项, 如果 200秒监控切换选项处于禁用状态, 感烟器可以在最长 18 个小时后生成错误。
如要设置无线监控窗口:

1. 输入安装人员设置段 [804][802]:
2. 通过滚动或输入热键的方式, 可以选择下面其中一个选项:
 - 00-禁用
 - 01-1小时后
 - 02-2小时后
 - 03-4小时后
 - 04-8小时后
 - 05-12小时后
 - 06-24小时后
3. 按 [*] 接受该选择。
4. 按 [#] 键, 退出该段。

注意: 对于获得 UL 认证的住宅盗警 (UL1023)、家庭保健 (UL1637) 和 ULC 住宅盗警 (ULC/ORD-C1023) 等安装, 监控窗口的最长时间将设为 24 小时。

对于获得 UL 认证的住宅火警 (UL985) 安装, 监控窗口的最长时间设为 200 秒。
对于获得 UL 认证的商业盗警 (UL1610/UL365) 和 ULC 住宅火警 (ULC-S545) 安装, 监控窗口的最长时间设为 4 小时。

[804][810] 无线选项 1

如要设置无线选项:

1. 输入安装人员设置段 [804][810]:
2. 通过滚动或输入热键的方式, 可以选择下面其中一个选项:
 - 01-射频怠工
 - 02-无线监控/射频阻塞报警
 - 03-无线篡改
 - 04-火警监控
3. 按 [*] 键接受该选择, 按 [#] 键退出。

[804][841] 运动摄像头

要设置运动摄像头:

1. 输入安装人员设置段 [804][841]:
2. 通过滚动或输入热键的方式, 可以选择下面其中一个选项:

[001]	可视验证	开:报警会触发 PIR 摄像头的图像捕捉功能。 关:报警不会触发 PIR 摄像头的图像捕捉功能。
[002]	查看时间窗口	01 报警 + 5 分钟 02 报警 + 15 分钟 03 报警 + 1 小时
[003]	查看其它报警	01 报警键启用/禁用 02 求救键启用/禁用 03 急救键启用/禁用 04 紧急键启用/禁用

[804][901]-[905] 删除无线设备

要删除无线设备:

1. 输入安装人员设置段 [804], 然后选择下面其中一个子段:
 [901]-删除无线防区设备
 [902]-删除无线钥匙
 [903]-删除报警器
 [904]-删除中继器
 [905]-删除键盘
2. 使用滚动键选择要删除的设备, 或输入热键直接进入特定设备。
3. 按 [*] 删除, 或 [#] 退出。

[804][921]-[925] 更换无线设备

通过此选项, 采用同一类型的另一设备更换系统上注册的故障设备, 同时保持原有配置。无需将出错设备删除。

要更换无线设备:

1. 输入安装人员设置段 [804], 然后选择下面其中一个子段:
 [921]-更换无线防区设备
 [922]-更换无线钥匙
 [923]-更换报警器
 [924]-更换中继器
 [925]-更换键盘
2. 按 [*] 选择一个子段。显示第一个可用设备。
3. 使用滚动键选择要更换的设备, 或输入热键直接进入特定设备。
4. 按 [*] 键。得到提示后, 激活该设备 完全注册 或输入设备 ID 预注册。此时会出现一条注册确认消息。

[804][990][001 - 005] 显示所有设备

使用该段检查系统上已注册的无线设备, 并查看与每台设备相关的系列号。

要检查无线设备信息:

1. 输入安装人员设置段 [804][990], 然后选择下面其中一个子段:
 - [001]-所有防区
 - [002]-中继器
 - [003]-报警器
 - [004]-无线钥匙
 - [005]-键盘
2. 按 [*] 选择无线设备类型。显示第一个可用设备。
3. 使用滚动键, 查看已注册的设备。

注意: 在 LED 或 ICON 键盘上不完全支持该选项。

[804][999] 复位成工厂默认值

选择该选项，会让 HSM2HOST 设置复位成工厂默认设置。

[904] 无线设备的位置测试

本试验用于确定无线设备的RF信号的状态，并且可以在一个系统小键盘或者在单独的设备来执行。这些说明适用于在键盘测试。有关放置在测试设备的说明，请参阅随无线设备的安装板。现有的测试模式如下：

- [904][001]-[128] - 测试无线防区
- [904][521]-[528] - 测试所有中继器
- [904][551]-[566] - 测试所有报警器
- [904][601]-[632] - 测试所有无线钥匙
- [904][701]-[716] - 测试所有键盘

提供两个测试结果：

- 24小时：在长达 24 小时的时间段内测得的信号平均强度。
- 现在：当前测试所得到的信号状态。

LED 故障指示灯闪烁，表明有 RF 干扰。可能会显示以下状态指示：

LCD 液晶显示屏	ICON 图标*	LED+	状态
强	1	9	信号强度高
好	2	10	信号强度高
差	3	11	信号强度差
未测试	5	13	如果没进行任何测试就显示“现在”结果
未测试	5	13	测试无线钥匙时，始终显示 24 小时的结果

*对于 Icon 键盘，第 1 位表示 24 小时的测试结果；第 2 位表示现在测试结果。

+对 LED 键盘，第一个数字表示 24 小时测试结果；第二个数字表示现在测试结果。

注意：

设置工作表

[000] 模块标签

[801]	键盘标签(1x14个字符)	
	001:	009:
	002:	010:
	003:	011:
	004:	012:
	005:	013:
	006:	014:
	007:	015:
	008:	016:

[802]	防区扩展模块标签(1x14个字符)	
	001:	009:
	002:	010:
	003:	011:
	004:	012:
	005:	013:
	006:	014:
	007:	015:
	008:	016:

[803]	输出扩展模块标签(1x14个字符)	
	001:	009:
	002:	010:
	003:	011:
	004:	012:
	005:	013:
	006:	014:
	007:	015:
	008:	016:

[806]	HSM2HOST标签(1x14个字符)	
	01:	

[809]	HSM2HOST电源标签(1x14个字符)	
	01:	
	02:	
	03:	
	04:	

[810]	HSM2204大电流输出标签(1x14个字符)	
	01:	
	02:	
	03:	
	04:	

[820]	报警器标签 (1x14个字符)
	01:
	02:
	03:
	04:
	05:
	06:
	07:
08:	

[821]	中继器标签 (1x14个字符)
	01:
	02:
	03:
	04:
	05:
	06:
	07:
08:	

[804][000] 无线设备注册 - 无线钥匙

键编号	子系统编号	用户	标签	键编号	子系统编号	用户	标签
1				17			
2				18			
3				19			
4				20			
5				21			
6				22			
7				23			
8				24			
9				25			
10				26			
11				27			
12				28			
13				29			
14				30			
15				31			
16				32			

[804][000] 无线设备注册 - 无线报警器

WLS报警器编号	子系统编号	报警器标签	WLS报警器编号	子系统编号	报警器标签
1			9		
2			10		
3			11		
4			12		
5			13		
6			14		
7			15		
8			16		

[804][000] 无线设备注册 - 无线键盘

WLS 键盘编号	键盘分配	键盘标签	WLS 键盘编号	键盘分配	键盘标签
1			9		
2			10		
3			11		
4			12		
5			13		
6			14		
7			15		
8			16		

[804][000] 无线设备注册 - 无线中继器

中继器编号	中继器标签
1	
2	
3	
4	
5	
6	
7	
8	

有限质量保证

DSC向购买者保证,在从购买之日起十二(12)个月内,在正常使用情况下,本产品不会出现材料和生产方面的缺陷。在保质期内,并在购买者将有缺陷的产品退回厂家的情况下,DSC将自行承担修理或更换有缺陷的产品,而且不收取劳务费和材料费。更换与修理后的零部件的质保期为该产品质量的剩余时间,或者从更换或修理产品之日起九十(90)天内,按时间长的为准。如果发现材料或生产方面存在缺陷,购买者必须立即以书面形式通知DSC,而且,不管发生任何情况,该书面通知应在产品质保期到期之前收到才算有效。DSC将对软件作出任何保证,所有软件产品都是作为随产品一起提供的软件许可协议条款规定的用户许可证进行出售。客户应承担选择、安装、操作和维护从DSC购买的任何产品的责任。对于定制产品,DSC只保证更换或修理交货时工作不正常的产品。在上述情况下,DSC可以自行决定是更换还是赔偿。

国际客户保证

对于国际客户的保证与对加拿大和美国范围内的任何客户的保证相同,但DSC不负责支付任何海关费用、税或可能到期的增值税。

保证程序

此获得此保证规定的服务,请将有问题产品退回购买的地方。所有授权分销商和经销商都订有产品质量保证计划。此商品退回DSC之前,必须首先获得批准编号。DSC将不会接受没有事先获得批准就退回的商品。

下述情况将不属于产品质量保证范围

此保证仅适用于正常使用情况下出现相关的零部件和生产方面的缺陷,此保证不负责

- 运输或搬运中遭受的损坏;
- 由于灾害 如火灾、洪水、刮风、地震或闪电 导致的损坏;
- 由于超出DSC所能控制原因 如电压太高、机械冲击或潮湿损坏 导致的损坏;
- 由于未经授权而进行连接、改造、修改或使用外来零部件导致的损坏;
- 由外部设备 DSC 提供的外部设备除外 导致的损坏;
- 由于没有提供适当产品安装环境而造成的缺陷;
- 由于出于非产品设计目的而使用产品导致的损坏;
- 由于不当维修导致的损坏;
- 由于其他滥用、误操作或不正确使用产品情况导致的损坏。

保证中的未尽事宜

除了不属于产品质量保证范围的事项以外,本产品还不应将下列事项包含在内:(i) 维修中心的货运成本,(ii) 产品没有DSC产品标签和批号或序列号;(iii) 以下测试拆卸或修理产品:对产品产生负面影响或导致正确检验或测试不能进行,因而无法核实购买者提出的产品质量保证要求是否有有效。DSC将自行承担赔偿或更换为在质保期内更换而退回的缺陷产品或标签。本保证不包含对于老化、滥用或损坏导致超出保证范围的产品进行鉴定,并提供修理概算。只有在从客户那里收到有效购买订单且 DSC 客户服务部发放退货批准编号 (RMA) 后,才会进行修理工作。

DSC 对在合理尝试次数后仍然无法修好的产品责任将限于更换产品,作为对违反产品质量保证的唯一赔偿。无论在任何情况下,DSC都不对由于违反此保证、违反合同、疏忽、严格赔偿责任或任何其他法律而造成的任何特殊的、偶然的或间接的损失负责。上述损失包括,但不限于,利润损失、产品或任何关联设备丢失、资本耗费、替代或更换设备费用、设施或服务费用、停机损失、购买者的时间损失、第三方的索赔 包括客户款项以及财产损失。有些国家或地区的法律限制或不允许免除间接损失的责任。如果此类国家或地区的法律适用于 DSC 提出的或针对 DSC 的任何索赔,本文件中包含的限制于免责声明此依照法律许可的最大程度执行。有些州不允许排除或限制偶然或间接损失,因此此条款可能不适用于您。

保证的免责声明

此保证包含完整的保证,并取代任何和所有其他保证,无论是明示还是默示的保证 包括对于适用性或特定适宜性的所有默示的保证。在DSC应承担的所有其他义务或责任之中,DSC既不承认,也不授权声称代表DSC的任何其他人、修改或更改此保证,也不让DSC承认与此产品相关的任何其他他人保证或责任。此保证的免责声明和有效保证受加拿大、美国、多省法律制约。警告: DSC建议对有此系统运行此期间测试。但是,不管是经常测试,但由于不局限于 发生非法篡改或电器干扰,此产品也可能无法正常工作。

超出保证期的修理对于按照下此条件退回厂家的超出保证期的产品,

DSC将自行决定进行修理还是更换。此商品退回DSC之前,必须首先获得批准编号。DSC将不会接受没有事先获得批准就退回的商品。DSC确定可以修理的产品将进行修理并返还,并对每个修理的设备收取一笔固定费用。DSC已预先确定具体费用标准,而且可能随时进行修理。DSC确定不能修理的产品将用功能接近的产品进行更换。每个更换设备将收取相当于当前市场价格的费用。

警告 请仔细阅读

安装人员须知

本警告包含重要信息。作为与系统用户接触的唯一一个人,您有责任让您的系统的用户注意本警告中的各项内容。

系统故障

此系统经过精心设计,可实现最大程度的有效性。然而,在涉及火灾、盗窃或其它类型的紧急事件情况下,此系统可能无法起到防护作用。由于种种原因,任何类型的任何报警系统都可能谨慎平衡处理,否则可能无法按照预期方式工作。下面介绍其中一些 但并非全部 原因:

安装不当

安全系统安装正确,才能提供充分保护。每次安装均应该经过安全专业人士鉴定,以确保涵盖所有入口点和区域。门窗上的锁和插销必须平整,且正常工作。门窗、墙壁和其建筑材料必须具有合格的抗力和构造,才能提供应有的保护水平。在任何建筑活动期前和之后,都必须进行一次重新鉴定。尽可能由消防和/或公安部门进行鉴定。

犯罪知识

此系统包含有制造时确定有效的安全功能。具有犯罪倾向的人可能会研究出 降低这些功能的有效性的方法。因此,定期检查安全系统非常重要,这样可以确保安全系统的功能保持有效,并确保一旦发现安全系统不能提供应有的保护,就马上更新或更换安全系统。入侵者进入入侵者可能会通过不受保护的入口点进入、避开传感设备、穿越安全系统检测不到的区域逃避监测、断开报警设备或干扰阻止系统正常工作。

电源故障

控制单元、入侵检测器、烟感以及许多其它安全设备都需要一个合格的电源,才能正常工作。如果某个设备通过电池工作,电池可能会失效,即使电池没有失效,也必须给电池充电,保持电池完好无损且正确安装。如果一个设备仅通过交流电工作,任何中断 无论时间多短 都会使该设备在断电时无法工作。供电中断 无论多长时间 都会伴随着有电压波动,这会损坏像安全系统这样的电子设备。发生断电后,请立即全面地检测系统,以确保系统正常工作。

可更换电池发生故障

此系统的无线发射器设计为正常情况下电池可以工作多年。预期电池寿命是设备环境、设备使用情况和设备类型的一个函数。环境情况 如高湿、高温或低温或温度大幅波动 可能会缩短预期电池寿命。尽管每个发射器都配备了有电量监视器,该监视器确定何时需要更换电池,该监视器可能无法正常工作。定期检测和维护可使系统处于良好的工作状态。

射频(无线)设备的危害

信号并不一定在各种情况下都能到达接收器,这些情况包括:在无线路径上或附近放置了金属物体、故意干扰或其它非有意

系统用户

用户可能无法操作应急开关,这可能是由于永久或暂时身体残疾、无法及时接近设备或不熟悉正确操作。重要的是,应培训所有系统用户正确操作报警设备,并让他们知道,当系统显示警报时如何做出反应。

烟感

烟感是此系统的一个部分,它可能由于种种原因而无法正确警告居住者防止火灾,下面列出其中一些原因。烟感可能没有正确安装或固定,关闭可能无法到达烟感,例如,火灾在烟囱、墙壁或屋顶或在关闭的门的其他一边发生。烟感可能监测不到住处或建筑物另一高度上发生的另一次火灾的烟雾。同样有效地方火灾产生的烟雾量和燃烧速度都是不同的。烟感可能无法同样有效地监测到各种类型的火灾。烟感可能不会及时对粗心大意或安全事故导致火灾发出警告,例如,床上冒烟、剧烈爆炸、燃气泄露、易燃材料存放不当、电路负荷过重、儿童玩火或人为纵火。即使烟感正常工作,在某些情况下,由于警告不够,而使所有居住者不能全部及时逃离,免受损伤或致死。

移动探测器

移动探测器只能探测到如相应安装说明书中所述的指定范围内的运动。它们无法辨别入侵者和预定居住者。移动探测器不提供客厅区域保护。移动探测器具有多个探测波束,只能探测到这些波束覆盖的无障碍区域中发生的运动。移动探测器无法探测到墙壁、天花板、地板、关闭的门、玻璃隔板或玻璃门窗后面发生的运动。任何类型的损害,无论是有意还是无意的,例如,将任何材料造成、油漆或喷洒到监测系统镜头、镜面、视窗或任何其他部位,都会影响监测系统正常工作。探测红外外线移动探测器通过感应温度变化进行工作。但是,当温度接近或高于体温时或监测区域中或监测区域附近存在有有意或无意的热源时,就会降低探测红外外线移动探测器的有效性。其中某些热源可能会是加热器、散热器、火炉、烧烤架、壁炉、灯光、排气管、照明等,等等。

告警设备

如果有隔离端或隔离门,告警设备如报警器、警铃、报警喇叭或报警脉冲等可能不会向人员告警或唤醒熟睡中的人。如果告警设备安装在住处或场地的不同水平上,则可能不会告警或唤醒居住者。音响告警设备可能会受到其它噪声源的干扰,如立体声系统、收音机、电视、空调或其它电器设备或过车辆等。音响告警设备尽管声音很高,但是有听觉障碍的人也可能听不到。

电话线

如果使用电话线发送报警,电话线可能会在某些时段不能使用或占线。而且,入侵者可能会切断电话线,或者会使用很难探测到的更先进的手段使其无法工作。

时间不充足

在某些情况下,系统会正常工作,但由于居住者无法及时响应报警,因而无法避免紧急事件发生。如果居住者受到监控,可能不会及时发生响应,导致无法保护居住者或其财物。

组件故障

尽管已经采取各种措施使此系统尽可能可靠,但是系统可能会由于组件故障而无法正常工作。

测试不当

通过定期测试和维护,可以发现使报警系统无法正常工作的问题。应每周测试整个系统,而且应在闯入、试图闯入、火灾、暴风雨、地震、事故或房屋内外任何建筑物活动之后,对整个系统进行测试。测试应包括所有监测设备、键盘、控制台、报警设备以及属于系统组成的任何其它操作设备。

安全与保险

不管其功能如何,报警系统不能取代财产保险或人寿保险。报警系统也无法取代财产所有者、租赁者或其他居住者,采取必要措施防止紧急情况发生,或最大程度地减少紧急情况造成的任何不良影响。

重要 - 请仔细阅读;无论是单独购买,还是产品和部件附带的

DSC软件,其版权都有归属,对其购买要遵循以下条款:

1. 该最终用户许可协议("EULA")是您已获取该软件和相关硬件的公司、个人和团体和 Tyco Safety Products Canada Ltd.分公司——Digital Security Controls "DSC" 之间的法律协议。该公司是集成安防系统的制造商,也是您已获取的该软件和关联硬件或部件的开发商。

2. 如果DSC软件产品“软件产品”或“软件”和硬件绑定销售,但没有和新硬件绑定,那么您不能使用、拷贝或安装软件产品。软件产品包括计算机软件,可能还有相关多媒体、印刷资料 and 在线或电子文档。

3. 提供与另外最终用户许可协议相关的软件产品时附带的任何软件按照该许可协议条款对您实行授权。

4. 一旦安装、复制、下载、储存、访问或使用了软件产品,您将无条件同意接受本EULA条款,即使本EULA被视为是先前协议或合约的修订。如果您不同意该EULA中条款,DSC则不能将SOFTWARE PRODUCT授权给您,您则无权使用它。

5. 软件产品许可
本软件产品受版权法、国际版权条约和其他相关知识产权法和条款保护。本软件仅授权您使用,非出售。

1. 协议授予 本EULA授予您以下权利:
(a) 软件安装与使用- 对于您获得的每个许可,您可以安装仅一份软件产品拷贝。
(b) 存储/网络应用- 不能同时在或从不同计算机中安装、访问、显示、运行、共享或使用该软件产品,包括工作站、终端、或其他数字电子设备,换言之,如果您有几个工作站,那么你必须为每个要应用该软件的工作站获取一个许可证。
(c) 备份拷贝 备份拷贝您可以多次备份拷贝该软件产品。但是在给定时间仅允许安装每个许可的一份拷贝。备份拷贝仅限于存档。除在本协议中明确说明,否则不得另外复制本软件产品,包括其印刷品。

2. 其他权利和限制说明
(a) 反向工程,反编译,反汇编限制除非或仅在法律明确准许范围之内 尽管有此限制,否则您不能对本软件实施反向工程、反编译或反汇编。未经DSC官方书面允许,您不能改变或修改该软件。但不能从软件删除任何官方标记、商标或标志。您要采取合理措施来确保符合EULA的条款和条件。

(b) 组件拆分- 本软件产品作为独立的软件产品进行授权。它的组件不能被拆分、并用于一个以上的硬件单元。
(c) 单一集成产品- 如果您在购买硬件的情况下获取本软件,那么软件产品和硬件作为一个独立的集成产品被授权。在这种情况下,正如EULA所述一样,仅在使用硬件时才能使用软件产品。

(d) 不得出租、租赁或出借本软件产品。也不得转予他人使用,或在服务器或网站上发布。

(e) 软件产品转让- 如果您没有保留任何拷贝并且您要转让全部软件产品 包括部件、多媒体和印刷材料,任何升级版本和该EULA,如果接收者同意EULA中条款,那么您可以将您所有EULA授予的权利仅作为永久销售的一部分转让给硬件转让。如果本软件产品是旧版本的更新,转让必须包含所有旧版软件产品。

(f) 终止- 如果您违反了EULA条款和条件,DSC在不伤害您其他权利的情况下终止该EULA。在这种情况下,您必须销毁所有软件产品拷贝及其所有部件。

(g) 商标- 本协议并未授权您使用任何DSC商标或其供应商的商标。

3. 版权- 本软件产品、附带印刷材料及软件拷贝中的所有所有权和知识产权(包括但不限于软件中的图片、照片和文字)归DSC或其供应商所有。不得复制附带的印刷材料。通过使用该软件产品而获悉的某些内容的所有权和知识产权属于这些内容的拥有者,并接受授权或其他知识产权法和条约保护。

4. 如果您没有授权您使用这些内容,EULA没有明确授予的所有权利归DSC及其供应商所有。

4. 出口限制- 不得将本软件产品出口或转出口到任何受加拿大出口限制的国家、个人或团体。

5. 法律管辖- 本软件许可协议受加拿大安大略省法律管辖。

6. 仲裁- 由本协议引发的所有争议将根据仲裁法进行仲裁。仲裁是终局的,对双方均有约束力。双方都要服从仲裁决定。仲裁地点应在加拿大,多伦多,仲裁语言应为英语。

7. 有限担保
(a) 免除担保- DSC只“按原样”提供软件本身,并不作其他方面的担保。DSC不能保证该软件能满足您的需要,其运行无障碍、无错误。

(b) 改变运行环境- 针对因硬件操作环境改变或非DSC软件产品进行交互引起的问题,DSC不负责任。

(c) 赔偿责任限制:保证中的风险分配;在任何情况下,如果任何法令包含了该许可协议中没有阐述的担保或条件,根据该许可协议条款,DSC的全部责任局限于在您为该软件产品的许可协议实际支付的数额和5加元 CAD\$5.00 中选择较大的数额作为赔偿。因为有些司法管辖区不允许排除或限制间接或意外损坏,所以上述限制可能对您不适用。

(d) 免责声明 - 本担保涵盖完整的担保条款,并取代任何及所有其他担保,无论是明示还是暗示(包括适销性和特定适宜性的所有暗示保证),也取代DSC的所有其他责任或义务。DSC不承诺其他担保,不委托或授权他人修改或改变该担保,不承担关于该软件产品的其他担保和责任。DSC不承诺其他担保,不委托或授权他人修改或改变该担保,不承担关于该软件产品的其他担保和责任。

(e) 免除赔偿和 担保限制 - 在任何情况下,针对因违反该担保、协议,或因法律疏忽和严重错误,或以其他法律理论为基础而产生的任何特殊的、意外的、继发的或间接的损坏,DSC不承担任何责任。这种损害包括,但不限于,利润损失,软件产品或任何相关的设备损坏,资金成本,替代或更换设备的费用,设施或服务,停机时间,购买时间,包括客户的第三方索赔和财产损失。

警告: DSC推荐对整个系统定期进行系统检测。但是,不管是否经常测试,由于 但不局限于 发生非法篡改或电器干扰,此产品也可能无法正常工作。

监管机构声明

根据EN50131-1:2006+A1:2009、EN50131-3:2009 Type B和EN50131-1: 2006+A1:2009、EN50131-5-3:2005+A1:2008标准，本产品符合II类2级设备的要求。

注：仅适用于EN50131标准的设施，报警系统的入侵部分已被调查。火灾报警及辅助医学报警功能没有包括在本产品根据上述标准的要求进行评估。根据针对II类2级设备的EN50131-1:2006 + A1:2009、EN50131-5-3:2005 +A1:2008标准，当HSM2HOST8型号的输出模块安装在PCS003C 可拆卸门 外壳时，该模块由Telefication进行认证。

Hereby, DSC, declares that this device is in compliance with the essential requirements and other relevant provisions of Directive 1995/5/EC.
The complete R&TTE Declaration of Conformity can be found at http://www.dsc.com/dgna_3436.aspx

(CZE) DSC jako výrobce prohlašuje, že tento výrobek je v souladu se všemi relevantními požadavky směrnice 1995/5/EC.
(DAN) DSC erklærer hermed at denne komponent overholder alle vigtige krav samt andre bestemmelser gældende 1995/5/EC.
(DUT) Hierby verklaart DSC dat dit toestel in overeenstemming is met de essentiele eisen van richtlijn 1995/5/EC.
(FIN) DSC vakuuttaa täten: tässä oleva ohjelma täyttää 1995/5/EC ohjeistuksen vaatimukset.
(FRE) Par la présente, DSC déclare que ce dispositif est conforme aux exigences essentielles et autres dispositions pertinentes de la Directive 1995/5/EC.
(GER) Hierdurch erklärt DSC, daß dieses Gerät den erforderlichen Bedingungen und Voraussetzungen der Richtlinie 1995/5/EC entspricht.
(GRE) Από τού παρόντος, ο DSC, δηλώνει ότι αυτός ο εξοπλισμός πληροί τις ουσιώδεις απαιτήσεις και άλλες διατάξεις σχετικά με την Οδηγό 1995/5/EC.
(ITA) Con la presente la Digital Security Controls dichiara che questo prodotto è conforme ai requisiti essenziali ed altre disposizioni rilevanti relative alla Direttiva 1995/5/EC.
(JPN) DSC 告知するに、この装置は、1995/5/EC の規定に適合するものと見なされ、また、関連する規定も満たしている。
(POL) DSC oświadcza, że urządzenie jest w zgodności z zasadniczymi wymaganiami oraz pozostałymi istotnymi postanowieniami Dyrektywy 1995/5/WE.
(POR) Por a presente, a DSC, declara que este equipamento está em conformidade com os requisitos essenciais e outras disposições relevantes da Directiva 1995/5/CE.
(SPA) Por la presente, DSC, declara que este equipo está en conformidad con los requisitos esenciales y otras disposiciones relevantes de la Directiva 1995/5/CE.
(SWE) DSC bekräftar härmed att denna apparat uppfyller de väsentliga kraven och andra relevanta bestämmelser i Direktivet 1995/5/EC.

版权所有©2015 Tyco Security Products。保留所有权利。www.dsc.com

本手册中所包含的商标、标识、服务标记已在【美国或其他国家】注册。严禁任何不当使用，如有违反，Tyco 将在法律许可的最大范围内积极保护其知识产权，包括诉诸刑事法律。Tyco Safety 所有的商标是其各自所有者的财产，须经许可可使用或适用法律允许方可使用。产品和技术规格如有变更，恕不另行通知 实际产品可能与照片有所不同。并非所有的产品会包括所有功能。会因地区而异，具体请联系您的销售代表。

DSC

From Tyco Security Products



29009347R001

HSM2HOST 2-Way Wireless Transceiver

V1.1 Installation Guide



WARNING: This Manual contains information on limitations regarding product use and function and information on the limitations as to liability of the manufacturer. The entire manual should be carefully read.

Table of Contents

Specifications and Features	3
Compatible Wireless Devices	3
Safety Instructions	5
Introduction	6
Controls and Indicators	6
Status LEDs	6
Mounting	7
Connect the HSM2HOST	7
Enroll The HSM2HOST	7
Delete the HSM2HOST	7
Permanently Mount	8
Wireless Device Setup and Programming	8
804 000 Enroll Wireless Devices	8
804 001 -[716] Wireless Device Configuration	8
804 801 RF Jam Detect	9
804 802 Wireless Supervision Window	9
804 810 Wireless Option 1	9
804 841 Motion Cameras	10
804 901 -[905] Delete Wireless Devices	10
804 921 -[925] Replace Wireless Devices	10
804 990 001-005 Show All Devices	10
804 999 Reset to Factory Defaults	11
904 Placement Testing Wireless Devices	11
PROGRAMMING WORKSHEETS	11
000 Module Labels	11
804 000 Wireless Device Enrollment – Wireless Keys	14
804 000 Wireless Device Enrollment – Wireless Sirens	15
804 000 Wireless Device Enrollment – Wireless Keypads	15
804 000 Wireless Device Enrollment – Wireless Repeaters	16
FCC Compliance Statement	20

Specifications and Features

- Current Draw: 60mA
- Voltage: Draws current from the PowerSeries Neo alarm controller (10.8VDC to 12.5VDC) - (Limited Power Supply)
- Frequency: 433MHz (HSM2HOST4), 868MHz (HSM2HOST8), 912-919MHz (HSM2HOST9^{UL})
- Zones - can receive signals from up to 128 wireless zones, plus 16 wireless keypads. Also supports up to 32 wireless keys or 32 panic pendants and 16 sirens
- Supervisory - programmable supervisory window
- Can be wired up to 1000 ft. / 230 m from the main panel with 22 AWG wire
- Connects to Corbus
- Compatibility: The HSM2HOST is used with PowerSeries Neo alarm panels
- Operating temperature: NA= 0°C – +49°C (32-122°F); EU= -10°C – +55°C
- Relative humidity: 93% non-condensing
- Separate, built-in wall and case tamperers

Note: For Commercial BURG (UL) the Supervisory window shall be set to 4 hours.
For Residential Fire (UL/ULC) the Supervisory window shall be set to 200 seconds.
For Residential BURG (UL/ULC) the supervisory window shall be set to 24 hours.
For UL Home Healthcare applications the supervisory window shall be set to 24 hours
Only models operating in the band 912-919 MHz are UL/ULC listed where indicated. Only UL approved devices are to be used with UL/ULC listed systems.

Compatible Wireless Devices

The HSM2HOST_x (x= 4/8/9) can receive signals from the devices listed in the following chart. Please refer to the instruction sheet of the device for operating instructions. Throughout this document, x in the model number represents the operating frequency of the device as follows: 9 (912-919 MHz), 8 (868MHz), 4 (433MHz).

Alarm Controllers	
PowerSeries Neo alarm controllers	HS2128/HS2064/ HS2032/HS2016
Modules	
Wireless Keypads	HS2LCDWFx HS2LCDWF Px HS2LCDWFPVx
Wireless Devices	
Wireless PG smoke detector	PGx926 ^{UL}
Wireless PG smoke and heat detector	PGx916 ^{UL}
Wireless PG CO detector	PGx913
Wireless PG PIR motion detector	PGx904(P) ^{UL}
Wireless PG PIR + camera motion detector	PGx934(P) ^{UL}
Wireless Outdoor PG PIR + camera motion detector	PGx944
Wireless PG curtain motion detector	PGx924 ^{UL}
Wireless PG dual tech motion detector	PGx984(P)
Wireless PG mirror motion detector	PGx974(P) ^{UL}
Wireless PG outdoor motion detector	PGx994 ^{UL}
Wireless PG glass break detector	PGx912
Wireless PG shock detector	PGx935 ^{UL}
Wireless PG flood detector	PGx985 ^{UL}
Wireless PG temperature detector (indoor use)	PGx905 ^{UL}
Wireless PG key	PGx939 ^{UL}
Wireless PG key	PGx929 ^{UL}
Wireless PG panic key	PGx938 ^{UL}
Wireless PG 2-button key	PGx949 ^{UL}
Wireless PG indoor siren	PGx901 ^{UL}
Wireless PG outdoor siren	PGx911 ^{UL}
Wireless PG repeater	PGx920 ^{UL}
Wireless PG door/window contact	PGx975 ^{UL}
Wireless PG door/window contact w/ AUX	PGx945 ^{UL}

Safety Instructions

- This equipment must be installed by Service Persons only (a service person is defined as a person having the appropriate technical training and experience necessary to be aware of hazards to which that person may be exposed in performing a task and of measures to minimize the risks to that person or other persons). It must be installed and used within a non-hazardous, indoor environment only (pollution degree max 2, over voltages category II).
- The installer is responsible for instructing the system user in regards to electrical safety precautions when using a system which includes this equipment and also in regards to each of the following:
 - Do not attempt to service this product. There are no user serviceable parts inside. If servicing is required, it shall be referred to service persons only.
- Using adequate mounting means (e.g., plastic/metal anchors), secure the transceiver to the building structure before applying power.
- Internal wiring must be routed in a manner that prevents:
 - Excessive strain on wire and on terminal connections;
 - Loosening of terminal connections;
 - Damage to conductor insulation.

Only UL/ULC listed devices can be used in UL/ULC listed installations.

HSM2HOST9 is listed for UL Commercial Burglary, Residential Fire, Residential Burglary and Home Health Care, ULC Residential Fire and Residential Burglary:

UL1610 Central-Station Burglar Alarm Units

UL1023 Household Burglar-Alarm System Units

UL985 Household Fire Warning System Units

UL1637 Home Health Care Signaling Equipment

ULC-S545-02 Residential Fire Warning System Control Units

ORD-C1023-1974 Household Burglar-Alarm System Units

UL 609 Local Burglar Alarm Units and Systems

UL365 Police Station Connected Burglar Alarm Units and Systems

Introduction

The HSM2HOSTx two-way wireless transceiver adds wireless capability to PowerSeries Neo alarm controllers, model HS2128, HS2064, HS2032 or HS2016. This manual describes how to install, program and maintain the HSM2HOST. Note that only one HSM2HOST or one RFK keypad can be enrolled on the alarm system.

Controls and Indicators

Status LEDs

The LEDs on the front of the HSM2HOST provide feedback regarding the installation, operation and troubleshooting of the unit. The LEDs function as follows:

Red LED	Operation
Module Power Up:	On steady during module power-up sequence then off.
Firmware Update:	Slow flashing = update in progress Rapid flashing = update failed
Trouble Condition:	<ul style="list-style-type: none">• No trouble: 1 rapid flash every 10 seconds. If troubles are present, a series of flashes occur every 2 seconds. Each series of flashes indicate troubles as follows: <ul style="list-style-type: none">• 1 flash: Module not enrolled• 2 flashes: Loss of contact with module for over 60 seconds• 3 flashes: Corbus low voltage• 8 flashes: RF interference (jam condition)
Module Confirmation:	Flashes rapidly during module confirmation process.
Placement Test:	On steady when location is bad. Off when location is good.
Green LED	Operation
Placement Test:	On steady when location is suitable. Off when location is unsuitable. Note: For UL/ULC listed systems, signal must be “Strong”. See Wireless Device Status Indications on page 10 for details.

Tamper

The HSM2HOST has separate built-in wall and case tampers. The case tamper is disabled by default on the NA version (enabled on EU version). Section [804][810] option 3 enables or disables the case tamper. Enable or disable the wall tamper by fastening the breakaway wall tamper bracket securely to the wall using one of the supplied screws. The case tamper activates when the case is opened and restores when the case is closed. The wall tamper on the back of the unit is depressed by the mounting surface when properly installed. If the unit is removed, the tamper activates. Ensure the mounting surface is smooth and free of obstructions that block access to the rear of the unit. Electrical wires should not run over or under the module when it is mounted.

Note: The built-in wall and case tamper must be installed and enabled for UL/ULC listed Commercial/Residential Burglary applications.

Mounting

Note: Permanently mount the HSM2HOST receiver and wireless devices AFTER placement testing each device (See "[904] Placement Testing Wireless Devices" on page 11). Find a place that is:

- dry,
- within operating temperature range,
- central to the proposed placement of all wireless devices,
- as high as possible. The range is reduced if mounted below ground level,
- far from sources of interference, including: electrical noise (computers, televisions, electric motors, appliances, heating and air conditioning units), large metal objects like heating ducts and plumbing which may shield the electro-magnetic waves,
- smooth and free of obstructions that block access to the rear of the unit.

Connect the HSM2HOST

Caution: Remove all power (AC, DC, telephone lines) from the system while connecting modules to the Corbus.

To connect the HSM2HOST:

1. With the alarm panel powered down, connect the HSM2HOST to the four-wire Corbus of the alarm panel according to Figure 1.
2. Once the wiring is complete, power up the security system.

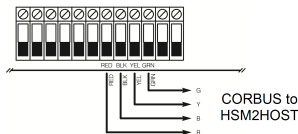

Figure: 1 Wiring Diagram

Enroll The HSM2HOST

The HSM2HOST must be enrolled onto the alarm panel before any wireless devices can be enrolled. When the alarm system is powered up for the first time, the first keypad or the HSM2HOST (if using a wireless keypad as the first keypad) can be enrolled.

To do this:

1. Once the HSM2HOST is wired to the alarm panel and power has been applied, power up a wireless keypad.
2. Press any button on the keypad to enroll it on the HSM2HOST. The HSM2HOST is then automatically enrolled on the alarm panel.

Alternately, enroll the HSM2HOST on the system at any time using the following procedure:

1. Enter Installer Programming section [902][000] (Auto Enroll All Modules).
2. When prompted, press [*] to enroll.

Delete the HSM2HOST

To remove the HSM2HOST from the system:

1. Enter Installer Programming section [902][106] (Delete HSM2HOSTx).
2. Press [*] to delete.

Permanently Mount

Once a suitable location is found, mount the HSM2HOST as follows:

1. Pull the Corbus wires through the holes at the back of the cabinet.
2. Mount the cabinet securely to the wall using the three screws supplied.
3. To enable the wall tamper, fasten the breakaway wall tamper bracket securely to the wall using the supplied screw.

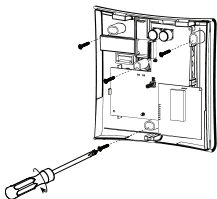

Figure: 2 Mounting the HSM2HOST

Wireless Device Setup and Programming

[804][000] Enroll Wireless Devices

1. Enter Installer Programming section [804][000].
2. When prompted, either activate the device (see device installation sheet) to enroll immediately or enter a device ID number. Do the latter to pre-enroll devices then enroll them later at the customer site. The alarm panel determines the type of device being enrolled and presents the appropriate programming options.
3. Use the scroll keys or type in the corresponding number to select an option.
4. Scroll through the available selections, key in a number or enter text as appropriate.
5. Press [*] to accept and move to the next option.
6. Once all options are configured, the system prompts to enroll the next device.
7. Repeat the process described above until all wireless devices are enrolled.

[804][001]-[716] Wireless Device Configuration

To configure wireless devices:

1. Enter Installer Programming section [804] then select one of the following sub-sections:
 - 001-128 – Configure Wireless Zones
 - 551-566 – Configure Wireless Sirens
 - 601-632 – Configure Wireless Keys
 - 701-716 – Configure Wireless Keypads

2. Select a device to configure using the scroll keys or go directly to a specific device by entering a hotkey.
3. Use the scroll buttons or enter a hotkey to select a configuration option for the device. See device sheets for details.
4. Press [*] to accept and move to the next option.
5. Once all options are configured, the system returns to the base configuration menu.
6. Repeat the process described above to configure other wireless devices.

[804][801] RF Jam Detect

To configure RF jamming:

1. Enter Installer Programming section [804][801] then select one of the following options:
 - 00–Disabled
 - 01–UL20/20-USA
 - 02–EN30/60-Europe
 - 03–Class 630/60-British
2. Press [*] to accept the selection.
3. Press [#] to exit the section.

[804][802] Wireless Supervision Window

For EN installations, 1 hour or 2 hours must be selected.

When option 06 is used, which configures the system to generate fault conditions after a device has been detected as absent for 24 hours, smoke detectors generate a fault condition after a maximum of 18 hours when the 200s supervision toggle option is disabled.

To program the Wireless Supervisory Window:

1. Enter Installer Programming section [804][802].
2. Select one of the following options by scrolling or entering the hotkey:
 - 00–Disabled
 - 01–After 1 Hour
 - 02–After 2 Hour
 - 03–After 4 Hour
 - 04–After 8 Hours
 - 05–After 12 Hours
 - 06–After 24 Hours
3. Press [*] to accept the selection.
4. Press [#] to exit the section.

Note: For UL Residential Burglary (UL1023), Home Health Care (UL1637), ULC Residential Burglary (ULC/ORD-C1023) installations, the maximum Supervision window shall be set to 24 hours.

For UL Residential Fire (UL985) installations, the maximum supervision window is set to 200s.

For UL Commercial Burglary (UL1610/UL365) and ULC Residential Fire (ULC-S545), the maximum supervision window shall be set to 4 hours.

[804][810] Wireless Option 1

To program wireless options:

1. Enter Installer Programming section [804][810].
2. Select one of the following options by scrolling or entering the hotkey:
 - 01–RF Delinquency
 - 02–Wireless Supervisory/RF Jam Alarm
 - 03–Wireless Tamper
 - 04–Fire Supervision
3. Press [*] to accept the selection and [#] to exit.

[804][841] Motion Cameras

To program motion cameras:

1. Enter Installer Programming section [804][841].
2. Select one of the following options by scrolling or entering the hotkey:

[001]	VisualVerification	On: Alarms trigger image capture from PIR Cameras Off: Alarms do not trigger image capture from PIR Cameras
[002]	ViewTime Window	01 Alarm + 5 Minutes 02 Alarm + 15 minutes 03 Alarm + 1 Hour
[003]	ViewOther Alarms	01 Fire key enabled/disabled 02 Duress enabled/disabled 03 Medical key enabled/disabled 04 Panic key enabled/disabled

[804][901]-[905] Delete Wireless Devices

To delete wireless devices:

1. Enter Installer Programming section [804] then select one of the following sub-sections:
[901] – Delete wireless zone devices
[902] – Delete wireless key
[903] – Delete sirens
[904] – Delete repeaters
[905] – Delete keypads
2. Select a device to delete using the scroll keys or go directly to a specific device by entering a hotkey.
3. Press [*] to delete or [#] to exit.

[804][921]-[925] Replace Wireless Devices

To replace a wireless device:

1. Enter Installer Programming section [804] then select one of the following sub-sections:
[921] – Replace wireless zone devices
[922] – Replace wireless key
[923] – Replace sirens
[924] – Replace repeaters
[925] – Replace keypads
2. Press [*] to select a sub-section. The first available device is displayed.
3. Select a device to replace using the scroll keys or go to a specific device by entering a hotkey.
4. Press [*]. When prompted, activate the device (full enrollment) or enter the device ID (pre-enrollment). A message is displayed confirming enrollment.

[804][990][001 – 005] Show All Devices

Use this section to review wireless devices enrolled on the system and to view serial numbers associated with each device.

To review wireless device information:

1. Enter Installer Programming section [804][990] then select one of the following sub-sections:
 - [001]–Allzones
 - [002]–Repeaters
 - [003]–Sirens
 - [004]–Wirelesskeys
 - [005]–keypads
2. Press [*] to select a wireless device type. The first available device is displayed.
3. Use the scroll keys to view the enrolled devices.

Note: This option is not fully supported by LED and ICON keypads.

[804][999] Reset to Factory Defaults

Selecting this option resets HSM2HOST programming to factory default settings.

[904] Placement Testing Wireless Devices

The following test modes are available:

- [904][001]-[128] – Test wireless zones
- [904][521]-[528] – Test all repeaters
- [904][551]-[566] – Test all sirens
- [904][601]-[632] – Test all wireless keys
- [904][701]-[716] – Test all keypads

Two test results are provided:

- 24-hour: Average results of signal strength testing over a 24-hour period.
- Now: Signal status results of the current test.

A flashing Trouble LED indicates RF interference. The following status indicators may be displayed:

LCD	Icon*	LED+	Status
Strong	1	9	Strong signal strength
Good	2	10	Good signal strength
Poor	3	11	Poor signal strength
NotTest	5	13	Displayed as the Now result if no test was performed
NotTest	5	13	Always displayed as the 24-hour result when testing wireless keys

*For Icon keypads, digit 1 indicates 24-hour test results; digit 2 indicates Now test results.

+For LED keypads, the first digit indicates 24-hour results; the second digit indicates Now test results.

Note: For EN/UL/ULC installations, only STRONG signal levels are acceptable.

PROGRAMMING WORKSHEETS

[000] Module Lables

[801]	KeypadLabel(1 x 14Characters)	
	001:	009:
	002:	010:
	003:	011:
	004:	012:
	005:	013:
	006:	014:
	007:	015:
	008:	016:

[802]	Zone Expander Label(1 x 14Characters)	
	001:	009:
	002:	010:
	003:	011:
	004:	012:
	005:	013:
	006:	014:
	007:	015:
	008:	016:

[803]	Output Expander Label(1 x 14Characters)	
	001:	009:
	002:	010:
	003:	011:
	004:	012:
	005:	013:
	006:	014:
	007:	015:
	008:	016:

[806]	HSM2HOSTLabel(1 x 14Characters)
	01:

[809]	HSM2300Power Supply Label(1 x 14Characters)
	01:
	02:
	03:
	04:

[810]	HSM2204High-Current Output Label(1 x 14Characters)
	01:
	02:
	03:
	04:

[820]	SirenLabels(1 x 14Characters)
	01:
	02:
	03:
	04:
	05:
	06:
	07:
08:	

[821]	RepeaterLabels(1 x 14Characters)
	01:
	02:
	03:
	04:
	05:
	06:
	07:
08:	

[804][000] Wireless Device Enrollment – Wireless Keys

Key#	Partition#	User	Label	Key#	Partition#	User	Label
1				17			
2				18			
3				19			
4				20			
5				21			
6				22			
7				23			
8				24			
9				25			
10				26			
11				27			
12				28			
13				29			
14				30			
15				31			
16				32			

[804][000] Wireless Device Enrollment – Wireless Sirens

WLS Siren#	Partition#	Siren Label	WLS Siren#	Partition#	Siren Label
1			9		
2			10		
3			11		
4			12		
5			13		
6			14		
7			15		
8			16		

[804][000] Wireless Device Enrollment – Wireless Keypads

WLS Keypad#	Keypad Assignment	Keypad Label	WLS Keypad#	Keypad Assignment	Keypad Label
1			9		
2			10		
3			11		
4			12		
5			13		
6			14		
7			15		
8			16		

[804][000] Wireless Device Enrollment – Wireless Repeaters

Repeater#	Repeater Label
1	
2	
3	
4	
5	
6	
7	
8	

LIMITED WARRANTY

Digital Security Controls warrants the original purchaser that for a period of twelve months from the date of purchase, the product shall be free of defects in materials and workmanship under normal use. During the warranty period, Digital Security Controls shall, at its option, repair or replace any defective product upon return of the product to its factory, at no charge for labour and materials. Any replacement and/or repaired parts are warranted for the remainder of the original warranty or ninety (90) days, whichever is longer. The original purchaser must promptly notify Digital Security Controls in writing that there is a defect in material or workmanship, such written notice to be received in all events prior to expiration of the warranty period. There is absolutely no warranty on software and all software products are sold as a user license under the terms of the software license agreement included with the product. The Customer assumes all responsibility for the proper selection, installation, operation and maintenance of any products purchased from DSC. Custom products are only warranted to the extent that they do not function upon delivery. In such cases, DSC can replace or credit at its option.

International Warranty

The warranty for international customers is the same as for any customer within Canada and the United States, with the exception that Digital Security Controls shall not be responsible for any customs fees, taxes, or VAT that may be due.

Warranty Procedure

To obtain service under this warranty, please return the item(s) in question to the point of purchase. All authorized distributors and dealers have a warranty program. Anyone returning goods to Digital Security Controls must first obtain an authorization number. Digital Security Controls will not accept any shipment whatsoever for which prior authorization has not been obtained.

Conditions to Void Warranty

This warranty applies only to defects in parts and workmanship relating to normal use. It does not cover:

- damage incurred in shipping or handling
- damage caused by disaster such as fire, flood, wind, earthquake or lightning;
- damage due to causes beyond the control of Digital Security Controls such as excessive voltage, mechanical shock, water damage;
- damage caused by unauthorized attachment, alterations, modifications or foreign objects;
- damage caused by peripherals (unless such peripherals were supplied by Digital Security Controls Ltd.);
- defects caused by failure to provide a suitable installation environment for the products;
- damage caused by use of the products for purposes other than those for which it was designed;
- damage from improper maintenance;
- damage arising out of any other abuse, mishandling or improper application of the products.

Items Not Covered by Warranty

In addition to the items which void the Warranty, the following items shall not be covered by Warranty: (i) freight cost to the repair centre; (ii) products which are not identified with DSC's product label and lot number or serial number; (iii) products disassembled or repaired in such a manner as to adversely affect performance or prevent adequate inspection or testing to verify any warranty claim. Access cards or tags returned for replacement under warranty will be credited or replaced at DSC's option. Products not covered by this warranty, or otherwise out of warranty due to age, misuse, or damage shall be evaluated, and a repair estimate shall be provided. No repair work will be performed until a valid purchase order is received from the Customer and a Return Merchandise Authorization number (RMA) is issued by DSC's Customer Service.

Digital Security Controls Ltd.'s liability for failure to repair the product under this warranty after a reasonable number of attempts will be limited to a replacement of the product, as the exclusive remedy for breach of warranty. Under no circumstances shall Digital Security Controls be liable for any special, incidental, or consequential

damages based upon breach of warranty, breach of contract, negligence, strict liability, or any other legal theory. Such damages include, but are not limited to, loss of profits, loss of the product or any associated equipment, cost of capital, cost of substitute or replacement equipment, facilities or services, down time, purchaser's time, the claims of third parties, including customers, and injury to property. The laws of some jurisdictions limit or do not allow the disclaimer of consequential damages. If the laws of such a jurisdiction apply to any claim by or against DSC, the limitations and disclaimers contained here shall be to the greatest extent permitted by law. Some states do not allow the exclusion or limitation of incidental or consequential damages, so that the above may not apply to you.

Disclaimer of Warranties

This warranty contains the entire warranty and shall be in lieu of any and all other warranties, whether expressed or implied (including all implied warranties of merchantability or fitness for a particular purpose) and of all other obligations or liabilities on the part of Digital Security Controls. Digital Security Controls neither assumes responsibility for, nor authorizes any other person purporting to act on its behalf to modify or to change this warranty, nor to assume for it any other warranty or liability concerning this product. This disclaimer of warranties and limited warranty are governed by the laws of the province of Ontario, Canada. **WARNING:** Digital Security Controls recommends that the entire system be completely tested on a regular basis. However, despite frequent testing, and due to, but not limited to, criminal tampering or electrical disruption, it is possible for this product to fail to perform as expected.

Out of Warranty Repairs

Digital Security Controls will at its option repair or replace out-of-warranty products which are returned to its factory according to the following conditions. Anyone returning goods to Digital Security Controls must first obtain an authorization number. Digital Security Controls will not accept any shipment whatsoever for which prior authorization has not been obtained.

Products which Digital Security Controls determines to be repairable will be repaired and returned. A set fee which Digital Security Controls has predetermined and which may be revised from time to time, will be charged for each unit repaired. Products which Digital Security Controls determines not to be repairable will be replaced by the nearest equivalent product available at that time. The current market price of the replacement product will be charged for each replacement unit.

WARNING – READ CAREFULLY

Note to Installers

This warning contains vital information. As the only individual in contact with system users, it is your responsibility to bring each item in this warning to the attention of the users of this system.

System Failures

This system has been carefully designed to be as effective as possible. There are circumstances, however, involving fire, burglary, or other types of emergencies which it may not provide protection. Any alarm system of any type may be compromised deliberately or may fail to operate as expected for a variety of reasons. Some but not all of these reasons may be:

Inadequate Installation

A security system must be installed properly in order to provide adequate protection. Every installation should be evaluated by a security professional to ensure that all access points and areas are covered. Locks and latches on windows and doors must be secure and operate as intended. Windows, doors, walls, ceilings and other building materials must be of sufficient strength and construction to provide the level of protection expected. A reevaluation must be done during and after any construction activity. An evaluation by the fire and/or police department is highly recommended if this service is available.

Criminal Knowledge

This system contains security features which were known to be effective at the time of manufacture. It is possible for persons with criminal intent to develop techniques which reduce the effectiveness of these features. It is important that a security system be reviewed periodically to ensure that its features remain effective and that it be updated or replaced if it is found that it does not provide the protection expected.

Access by Intruders

Intruders may enter through an unprotected access point, circumvent a sensing device, evade detection by moving through an area of insufficient coverage, disconnect a warning device, or interfere with or prevent the proper operation of the system.

Power Failure

Control units, intrusion detectors, smoke detectors and many other security devices require an adequate power supply for proper operation. If a device operates from batteries, it is possible for the batteries to fail. Even if the batteries have not failed, they must be charged, in good condition and installed correctly. If a device operates only by AC power, any interruption, however brief, will render that device inoperative while it does not have power. Power interruptions of any length are often accompanied by voltage fluctuations which may damage electronic equipment such as a security system. After a power interruption has occurred, immediately conduct a complete system test to ensure that the system operates as intended.

Failure of Replaceable Batteries

This system's wireless transmitters have been designed to provide several years of battery life under normal conditions. The expected battery life is a function of the device environment, usage and type. Ambient conditions such as high humidity, high or low temperatures, or large temperature fluctuations may reduce the expected battery life. While each transmitting device has a low battery monitor which identifies when the batteries need to be replaced, this monitor may fail to operate as expected. Regular testing and maintenance will keep the system in good operating condition.

Compromise of Radio Frequency (Wireless) Devices

Signals may not reach the receiver under all circumstances which could include metal objects placed on or near the radio path or deliberate jamming or other inadvertent radio signal interference.

System Users

A user may not be able to operate a panic or emergency switch possibly due to permanent or temporary physical disability, inability to reach the device in time, or unfamiliarity with the correct operation. It is important that all system users be trained in the correct operation of the alarm system and that they know how to respond when the system indicates an alarm.

Smoke Detectors

Smoke detectors that are a part of this system may not properly alert occupants of a fire for a number of reasons, some of which follow. The smoke detectors may have been improperly installed or positioned. Smoke may not be able to reach the smoke detectors, such as when the fire is in a chimney, walls or roofs, or on the other side of closed doors. Smoke detectors may not detect smoke from fires on another level of the residence or building.

Every fire is different in the amount of smoke produced and the rate of burning. Smoke detectors cannot sense all types of fires equally well. Smoke detectors may not provide timely warning of fires caused by carelessness or safety hazards such as smoking in bed, violent explosions, escaping gas, improper storage of flammable materials, overloaded electrical circuits, children playing with matches or arson. Even if the smoke detector operates as intended, there may be circumstances when there is insufficient warning to allow all occupants to escape in time to avoid injury or death.

Motion Detectors

Motion detectors can only detect motion within the designated areas as shown in their respective installation instructions. They cannot discriminate between intruders and intended occupants. Motion detectors do not provide volumetric area protection. They have multiple beams of detection and motion can only be detected in unobstructed areas covered by these beams. They cannot detect motion which occurs behind walls, ceilings, floor, closed doors, glass partitions, glass doors or windows. Any type of tampering whether intentional or unintentional such as masking, painting, or spraying of any material on the lenses, mirrors, windows or any other part of the detection system will impair its proper operation.

Passive infrared motion detectors operate by sensing changes in temperature. However their effectiveness can be reduced when the ambient temperature rises near or above body temperature or if there are intentional or unintentional sources of heat in or near the detection area. Some of these heat sources could be heaters, radiators, stoves, barbecues, fireplaces, sunlight, steam vents, lighting and so on.

Warning Devices

Warning devices such as sirens, bells, horns, or strobes may not warn people or awaken someone sleeping if there is an intervening wall or door. If warning devices are located on a different level of the residence or premise, then it is less likely that the occupants will be alerted or awakened. Audible warning devices may be interfered with by other noise sources such as stereos, radios, televisions, air conditioners or other appliances, or passing traffic. Audible warning devices, however loud, may not be heard by a hearing-impaired person.

Telephone Lines

If telephone lines are used to transmit alarms, they may be out of service or busy for certain periods of time. Also an intruder may cut the telephone line or defeat its operation by more sophisticated means which may be difficult to detect.

Insufficient Time

There may be circumstances when the system will operate as intended, yet the occupants will not be protected from the emergency due to their inability to respond to the warnings in a timely manner. If the system is monitored, the response may not occur in time to protect the occupants or their belongings.

Component Failure

Although every effort has been made to make this system as reliable as possible, the system may fail to function as intended due to the failure of a component.

Inadequate Testing

Most problems that would prevent an alarm system from operating as intended can be found by regular testing and maintenance. The complete system should be tested weekly and immediately after a break-in, an attempted break-in, a fire, a storm, an earthquake, an accident, or any kind of construction activity inside or outside the premises. The testing should include all sensing devices, keypads, consoles, alarm indicating devices and any other operational devices that are part of the system.

Security and Insurance

Regardless of its capabilities, an alarm system is not a substitute for property or life insurance. An alarm system also is not a substitute for property owners, renters, or other occupants to act prudently to prevent or minimize the harmful effects of an emergency situation.

IMPORTANT - READ CAREFULLY: DSC Software purchased with or without Products and Components is copyrighted and is purchased under the following license terms:

- This End-User License Agreement ("EULA") is a legal agreement between You (the company, individual or entity who acquired the Software and any related Hardware) and Digital Security Controls, a division of Tyco Safety Products Canada Ltd. ("DSC"), the manufacturer of the integrated security systems and the developer of the software and any related products or components ("HARDWARE") which You acquired.
- If the DSC software product ("SOFTWARE PRODUCT" or "SOFTWARE") is intended to be accompanied by HARDWARE, and is NOT accompanied by new HARDWARE, You may not use, copy or install the SOFTWARE PRODUCT. The SOFTWARE PRODUCT includes computer software, and may include associated media, printed materials, and "online" or electronic documentation.
 - Any software provided along with the SOFTWARE PRODUCT that is associated with a separate end-user license agreement is licensed to You under the terms of that license agreement.
 - By installing, copying, downloading, storing, accessing or otherwise using the SOFTWARE PRODUCT, You agree unconditionally to be bound by the terms of this EULA, even if this EULA is deemed to be a modification of any previous arrangement or contract. If You do not agree to the terms of this EULA, DSC is unwilling to license the SOFTWARE PRODUCT to You, and You have no right to use it.

SOFTWARE PRODUCT LICENSE

The SOFTWARE PRODUCT is protected by copyright laws and international copyright treaties, as well as other intellectual property laws and treaties. The SOFTWARE PRODUCT is licensed, not sold.

1. GRANT OF LICENSE This EULA grants You the following rights:
 - (a) Software Installation and Use - For each license You acquire, You may have only one copy of the SOFTWARE PRODUCT installed.
 - (b) Storage/Network Use - The SOFTWARE PRODUCT may not be installed, accessed, displayed, run, shared or used concurrently on or from different computers, including a workstation, terminal or other digital electronic device ("Device"). In other words, if You have several workstations, You will have to acquire a license for each workstation where the SOFTWARE will be used.
 - (c) Backup Copy - You may make back-up copies of the SOFTWARE PRODUCT, but You may only have one copy per license installed at any given time. You may use the back-up copy solely for archival purposes. Except as expressly provided in this EULA, You may not otherwise make copies of the SOFTWARE PRODUCT, including the printed materials accompanying the SOFTWARE.

2. DESCRIPTION OF OTHER RIGHTS AND LIMITATIONS

(a) Limitations on Reverse Engineering, Decompilation and Disassembly - You may not reverse engineer, decompile, or disassemble the SOFTWARE PRODUCT, except and only to the extent that such activity is expressly permitted by applicable law notwithstanding this limitation. You may not make any changes or modifications to the Software, without the written permission of an officer of DSC. You may not remove any proprietary notices, marks or labels from the Software Product. You shall institute reasonable measures to ensure compliance with the terms and conditions of this EULA.

(b) Separation of Components - The SOFTWARE PRODUCT is licensed as a single product. Its component parts may not be separated for use on more than one HARDWARE unit.

(c) Single INTEGRATED PRODUCT - If You acquired this SOFTWARE with HARDWARE, then the SOFTWARE PRODUCT is licensed with the HARDWARE as a single integrated product. In this case, the SOFTWARE PRODUCT may only be used with the HARDWARE as set forth in this EULA.

(d) Rental - You may not rent, lease or lend the SOFTWARE PRODUCT. You may not make it available to others or post it on a server or web site.

(e) Software Product Transfer - You may transfer all of Your rights under this EULA only as part of a permanent sale or transfer of the HARDWARE, provided You retain no copies, You transfer all of the SOFTWARE PRODUCT (including all component parts, the media and printed materials, any upgrades and this EULA), and provided the recipient agrees to the terms of this EULA. If the SOFTWARE PRODUCT is an upgrade, any transfer must also include all prior versions of the SOFTWARE PRODUCT.

(f) Termination - Without prejudice to any other rights, DSC may terminate this EULA if You fail to comply with the terms and conditions of this EULA. In such event You must destroy all copies of the SOFTWARE PRODUCT and all of its component parts.

(g) Trademarks - This EULA does not grant You any rights in connection with any trademarks or service marks of DSC or its suppliers.

3. COPYRIGHT - All title and intellectual property rights in and to the SOFTWARE PRODUCT (including but not limited to any images, photographs, and text incorporated into the SOFTWARE PRODUCT), the accompanying printed materials, and any copies of the SOFTWARE PRODUCT, are owned by DSC or its suppliers.

You may not copy the printed materials accompanying the SOFTWARE PRODUCT. All title and intellectual property rights in and to the content which may be accessed through use of the SOFTWARE PRODUCT are the property of the respective content owner and may be protected by applicable copyright or other intellectual property laws and treaties. This EULA grants You no rights to use such content. All rights not expressly granted under this EULA are reserved by DSC and its suppliers.

4. EXPORT RESTRICTIONS - You agree that You will not export or re-export the SOFTWARE PRODUCT to any country, person, or entity subject to Canadian export restrictions.

5. CHOICE OF LAW - This Software License Agreement is governed by the laws of the Province of Ontario, Canada.

6. ARBITRATION - All disputes arising in connection with this Agreement shall be determined by final and binding arbitration in accordance with the Arbitration Act, and the parties agree to be bound by the arbitrator's decision. The place of arbitration shall be Toronto, Canada, and the language of the arbitration shall be English.

7. LIMITED WARRANTY

(a) NO WARRANTY - DSC PROVIDES THE SOFTWARE "AS IS" WITHOUT WARRANTY. DSC DOES NOT WARRANT THAT THE SOFTWARE WILL MEET YOUR REQUIREMENTS OR THAT OPERATION OF THE SOFTWARE WILL BE UNINTERRUPTED OR ERROR-FREE.

(b) CHANGES IN OPERATING ENVIRONMENT - DSC shall not be responsible for problems caused by changes in the operating characteristics of the HARDWARE, or for problems in the interaction of the SOFTWARE PRODUCT with non-DSC-SOFTWARE or HARDWARE PRODUCTS.

(c) LIMITATION OF LIABILITY; WARRANTY REFLECTS ALLOCATION OF RISK - IN ANY EVENT, IF ANY STATUTE IMPLIES WARRANTIES OR CONDITIONS NOT STATED IN THIS LICENSE AGREEMENT, DSC'S ENTIRE LIABILITY UNDER ANY PROVISION OF THIS LICENSE AGREEMENT SHALL BE LIMITED TO THE GREATER OF THE AMOUNT ACTUALLY PAID BY YOU TO LICENSE THE SOFTWARE PRODUCT AND FIVE CANADIAN DOLLARS (CAD\$5.00), BECAUSE SOME JURISDICTIONS DO NOT ALLOW THE EXCLUSION OR LIMITATION OF LIABILITY FOR CONSEQUENTIAL OR INCIDENTAL DAMAGES, THE ABOVE LIMITATION MAY NOT APPLY TO YOU.

(d) DISCLAIMER OF WARRANTIES - THIS WARRANTY CONTAINS THE ENTIRE WARRANTY AND SHALL BE IN LIEU OF ANY AND ALL OTHER WARRANTIES, WHETHER EXPRESSED OR IMPLIED (INCLUDING ALL IMPLIED WARRANTIES OF MERCHANTABILITY OR FITNESS FOR A PARTICULAR PURPOSE) AND OF ALL OTHER OBLIGATIONS OR LIABILITIES ON THE PART OF DSC. DSC MAKES NO OTHER WARRANTIES. DSC NEITHER ASSUMES NOR AUTHORIZES ANY OTHER PERSON PURPORTING TO ACT ON ITS BEHALF TO MODIFY OR TO CHANGE THIS WARRANTY, NOR TO ASSUME FOR IT ANY OTHER WARRANTY OR LIABILITY CONCERNING THIS SOFTWARE PRODUCT. (e) EXCLUSIVE REMEDY AND LIMITATION OF WARRANTY - UNDER NO CIRCUMSTANCES SHALL DSC BE LIABLE FOR ANY SPECIAL, INCIDENTAL, CONSEQUENTIAL OR INDIRECT DAMAGES BASED UPON BREACH OF WARRANTY, BREACH OF CONTRACT, NEGLIGENCE, STRICT LIABILITY, OR ANY OTHER LEGAL THEORY. SUCH DAMAGES INCLUDE, BUT ARE NOT LIMITED TO, LOSS OF PROFITS, LOSS OF THE SOFTWARE PRODUCT OR ANY ASSOCIATED EQUIPMENT, COST OF CAPITAL, COST OF SUBSTITUTE OR REPLACEMENT EQUIPMENT, FACILITIES OR SERVICES, DOWN TIME, PURCHASERS TIME, THE CLAIMS OF THIRD PARTIES, INCLUDING CUSTOMERS, AND INJURY TO PROPERTY. WARNING: DSC recommends that the entire system be completely tested on a regular basis. However, despite frequent testing, and due to, but not limited to, criminal tampering or electrical disruption, it is possible for this SOFTWARE PRODUCT to fail to perform as expected.

FCC Compliance Statement

This equipment generates and uses radio frequency energy and if not installed and used properly, in strict accordance with the manufacturer's instructions, may cause interference to radio and television reception. It has been type tested and found to comply with the limits for Class B device in accordance with the specifications in Subpart "B" of Part 15 of FCC Rules, which are designed to provide reasonable protection against such interference in any residential installation. However, there is no guarantee that interference will not occur in a particular installation. If this equipment does cause interference to television or radio reception, which can be determined by turning the equipment off and on, the user is encouraged to try to correct the interference by one or more of the following measures:

- Re-orient the receiving antenna
- Relocate the alarm control with respect to the receiver
- Move the alarm control away from the receiver
- Connect the alarm control into a different outlet so the alarm control & receiver are on different circuits.

If necessary, the user should consult the dealer or an experienced radio/television technician for additional suggestions. The user may find the following booklet prepared by the FCC helpful: "How to Identify and Resolve Radio/Television Interference Problems". This booklet is available from the U.S. Government Printing Office, Washington, D.C. 20402, Stock # 004-000-00345-4.

IC Statement

This device complies with Industry Canada license-exempt RSS standard(s). Operation is subject to the following two conditions: (1) this device may not cause interference, and (2) this device must accept any interference, including interference that may cause undesired operation of the device.

Harvati, DSC, deklara da sta device je u skladu sa osnovnim zahtevima i drugim relevantnim zahtevima iz Direktive 1999/5/EC. The complete R&TTE Declaration of Conformity can be found at http://www.dsc.com/rftte_348a.asp

(CE) DSC jako výrobce prohlašuje, že tento výrobek je v souladu se všemi nezávadnými požadavky směrnice 1999/5/EC.

(DAN) DSC erklærer hermed at denne komponent overholder alle vigtige krav samt andre bestemmelser gældt direktiv 1999/5/EC.

(DUT) Hierby verklaart DSC dat dit toestel in overeenstemming is met de eisen en bepalingen van richtlijn 1999/5/EC.

(FIN) DSC vakuuttaa täten: tässä oleva ohjelma täyttää direktiivissä 1999/5/EC edellytetyt vaatimukset.

(FRE) Par la présente, DSC déclare que ce dispositif est conforme aux exigences essentielles et autres obligations prescrites de la Directive 1999/5/EC.

(GER) Hierdurch erklärt DSC, daß dieses Gerät den erforderlichen Bedingungen und Voraussetzungen der Richtlinie 1999/5/EC entspricht.

(GRE) Δια του παρόντος, η DSC, δηλώνει ότι αυτός ο εξοπλισμός είναι σε πλήρη συμμόρφωση με τα κείμενα και άλλες απαιτήσεις της Οδηγίας 1999/5/EC.

(ITA) Con la presente la Digital Security Controls dichiara che questo prodotto è conforme ai requisiti essenziali ed altre disposizioni rilevanti della Direttiva 1999/5/EC.

(JPN) DSC 断言するが、この装置は、EU の指令 1999/5/EC の規定に適合する。

(POL) DSC oświadczam, że urządzenie jest w zgodności z zasadniczymi wymaganiami oraz pozostałymi postanowieniami Dyrektywy 1999/5/EC.

(POR) Por la presente, a DSC, declara que este equipamento está em conformidade com os requisitos essenciais e outras disposições relevantes da Directiva 1999/5/EC.

(SPA) Por la presente, DSC, declara que este equipo está en conformidad con los requisitos esenciales y otras obligaciones relevantes de la Directiva 1999/5/EC.

(SWE) DSC bekräftar härmed att denna apparat uppfyller de väsentliga kraven och andra relevanta bestämmelser i Direktivet 1999/5/EC.

Le présent appareil est conforme aux CNR d'Industrie Canada applicables aux appareils radio exempts de licence. L'exploitation est autorisée aux deux conditions suivantes : (1) l'appareil ne doit pas produire de brouillage, et (2) l'utilisateur de l'appareil doit accepter tout brouillage radioélectrique subi, même si le brouillage est susceptible d'en compromettre le fonctionnement.

This Class B digital apparatus meets all requirements of the Canadian interference-causing equipment regulations.

Cet appareil numérique de la Classe B respecte toutes les exigences de règlement sur le matériel brouilleur du Canada.

IC:160A-HS2HOST9.

The term 'IC:' before the radio certification number only signifies that Industry Canada technical specifications were met.

EU Compliance Statement

The Model HSM2HOST8 Wireless Transceiver has been certified by Telecommunication according to EN50131-1:2006 + A1:2009 and EN50131-3:2009, for Grade 2, Class II.

Note: For EN50131 compliant installations only, the intrusion portion of the alarm system has been investigated. Fire Alarm and Auxiliary (Medical) Alarm functions were not included in the evaluation of this product under the

requirements of the above mentioned standards.

© 2014 Tyco Security Products. All Rights Reserved. www.dsc.com

The trademarks, logos, and service marks displayed on this document are registered in the United States [or other countries]. Any misuse of the trademarks is strictly prohibited and Tyco will aggressively enforce its intellectual property rights to the fullest extent of the law, including pursuit of criminal prosecution wherever necessary. All trademarks not owned by Tyco are the property of their respective owners, and are used with permission or allowed under applicable laws. Product offerings and specifications are subject to change without notice. Actual products may vary from photos. Not all products include all features. Availability varies by region; contact your sales representative.

DSC

From Tyco Security Products



29009205R001