

# PK5500 v1.3

## Installation Instructions / 安装说明

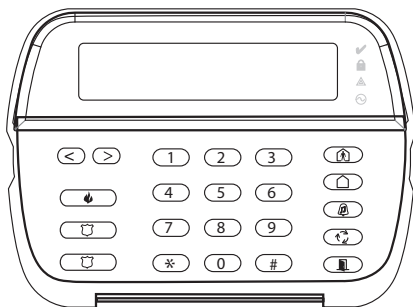

**WARNING:** Please refer to the System Installation Manual for information on limitations regarding product use and function and information on the limitations as to liability of the manufacturer.

**NOTE:** These instructions shall be used in conjunction with the system Installation Manual of the Control Panel with which this equipment is intended to be used.

**警告 -** 本手册包含有关产品使用和功能的限制信息以及有关制造厂商的责任限制的信息。请认真阅读整本手册。

**注意：** 这些说明必须同设备控制面板的《系统安装手册》一起使用。

# DSC

A Tyco International Company

## PowerSeries™

### SECURITY SYSTEM

# CE



29008941R001

The PK5500 keypad can be used on security systems with up to 64 zones. These keypads are compatible with the latest version of the following DSC security systems:

- PC580      • PC585      • PC1555MX      • PC1565
- PC1616      • PC1832      • PC1864      • PC5005
- PC5008      • PC5010      • PC5015      • PC5016
- PC5020

## Specifications

- Temperature range: -10°C to +55°C (14°F to 131°F)
- Humidity (MAX): 93% R.H., non-condensing
- Plastic enclosure protection degree: IP30, IK04
- Voltage rating: 12Vdc nominal
- Connects to control panel via 4-wire Keybus
- 1 keypad zone input/PGM output\*
- PK5500 Current Draw: 50mA (standby)/125mA (maximum)
- Wall mount tamper
- 5 programmable function keys
- Ready (Green LED), Armed (Red LED), Trouble (Yellow LED), AC (Green LED)
- Low temperature sensor: Alarm 6°C (43°F)/Restore 9°C (48°F)

**NOTE:** \* Zone not to be programmed as Fire type or 24h type.

## Unpacking

The Power keypad package includes the following parts:

- One Power keypad
- Keypad inner door labels
- Four mounting screws
- 1 tamper switch
- 2 end-of-line resistors
- Installation Instructions

## Mounting

Mount the keypad where it is accessible to designated points of entry and exit. Once you have selected a dry and secure location, perform the following steps to mount the keypad.

## Disassemble Keypad

1. Insert a flat head screwdriver into the provided slot (first of two).
2. Move screwdriver toward the back plastic and lift as in the following diagram. This will unhook one side of the front plastic.
3. Repeat step # 1 and 2 on the second provided slot to disconnect the front plastic and allow access for wiring.

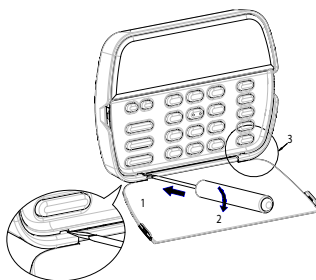

## Mount and Wire Keypad

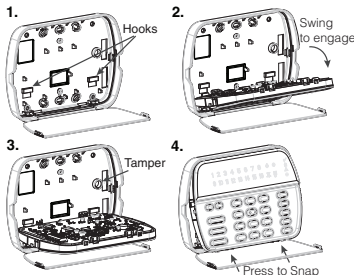
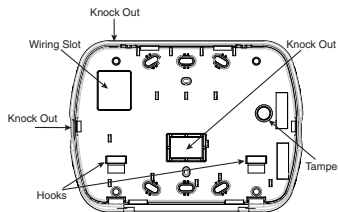

1. Secure keypad to wall by using mounting holes. Use all 4 screws provided unless mounting on a single gang box.
2. Place keypad into hooks on the backplate and swing down to engage.
3. Run wire through wiring slot or knockouts. Connect Keybus and PGM/Zone wiring to keypad. Place tamper switch into tamper hole on backplate.
4. Remove keypad from hooks. Place keypad into backplate, ensure the wire is pushed back into the wall as much as possible. Route the wire inside the keypad ensuring high components are avoided. Snap the front assembly closed, ensuring there is no pressure to the keypad from the wire below.

**NOTE:** If any tension found between the front keypad assembly and wiring, please open the keypad reroute the wire and close again. Repeat these steps until the keypad is closed properly.

## Wiring

1. Before wiring the unit, ensure that all power (AC transformer and battery) is disconnected from the control panel.
2. Connect the four Keybus wires from the control panel (red, black, yellow and green) to the keypad terminals. Refer to diagram.
3. If programmed as an input, you can connect a device - such as a door contact - to the "P/Z" terminal of the keypad. This eliminates the need to run wires back to the control panel for the device. To connect the zone, run one wire from the device to the "P/Z" terminal and the other wire from the device to the B (black) terminal. For powered devices, run the red wire to the R (positive) terminal and the black wire to the B (negative) terminal. When using end of line supervision, connect the zone according to one of the configurations outlined in your system's Installation Manual.
4. If the P/Z terminal is programmed as an output, the output follows the PGM programmed in Section [080]. A small relay, buzzer or other DC operated device may be connected between the positive supply voltage and the P/Z terminal (maximum load is 50mA).

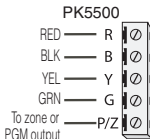

## Applying Power

Once all wiring is complete, and the equipment is secured to the building structure with at least two screws apply power to the control panel:

1. Connect the battery leads to the battery.
2. Connect the AC transformer.

For more information on control panel power specifications, see the control panel Installation Manual.

Operating Instructions shall be made available to the user.





# Keypad Enrollment

Enter keypad programming by pressing [\*][8][Installer's Code][000].

## [0] Partition / Slot Assignment

Digit	Option	Valid Range	Default	
1st	Partition Assignment (0=Global Keypad)	0 to 8	1	<input type="text"/>
2nd	Slot Assignment	1 to 8	8	<input type="text"/>

## [1]-[5] Function Key Assignment

	Function Key	Button	Valid Range	Default	Function	
[1]	Function Key 1 Assignment		00 to 32	03	Stay Arm	<input type="text"/>
[2]	Function Key 2 Assignment		00 to 32	04	Away Arm	<input type="text"/>
[3]	Function Key 3 Assignment		00 to 32	06	Chime On/Off	<input type="text"/>
[4]	Function Key 4 Assignment		00 to 32	14	Sensor Reset	<input type="text"/>
[5]	Function Key 5 Assignment		00 to 32	16	Quick Exit	<input type="text"/>

## Keypad Function Keys

Refer to your system installation manual for a complete list of all function key options available for your system.

[00] - Null	[08] - Bypass Mode	[16] - Quick Exit	[26] - Time & Date Program
[01] - Partition 1 Select	[09] - Trouble Display	[17] - Activate Stay/Away	[27] - Partition 3 Select
[02] - Partition 2 Select	[10] - Alarm Memory	[18] - *Global Away Arm	[28] - Partition 4 Select
[03] - Stay Arm	[11] - User Programming	[19] - Command Output 3	[29] - Partition 5 Select
[04] - Away Arm	[12] - User Functions	[21] - Command Output 4	[30] - Partition 6 Select
[05] - No Entry Arm	[13] - Command Output 1	[22] - *Global Disarming	[31] - Partition 7 Select
[06] - Chime On/Off	[14] - Command Output 2	[23] - Bypass Recall	[32] - Partition 8 Select
[07] - System Test	[15] - *Global Stay Arm	[24] - Bypass Group Recall	[33] - Local PGM Activate

\*Available only on the PC1616/PC1832/PC1864 version 4.2 or higher.

## Keypad Programming

Enter keypad programming by pressing [\*][8][Installer Code][\*]

### [001]-[064] Zone Label 1 to 64

ex. For Zone 1 enter section [001], for Zone 2 enter section [002] etc. Default: "Zone 1" - "Zone 64"

Section	Zone	Label
[001] to [064]	1 to 64	<input type="text"/>



OFF  
[F]ire Key Disabled  
[P]anic Key Disabled

OFF  
Display "Xs" when Programming  
Local Clock Display Off  
Local Clock Displays AM/PM  
Auto Alarm Memory Scroll Disabled  
Local Display of Temperature OFF  
Bypass Options prompt OFF  
Auto-Scroll Open Zones OFF

**OFF**  
Chime Disabled for Zone Openings  
Chime Disabled for Zone Closings  
5th Terminal is Keypad Zone Input  
Language Selection Disabled  
Power LED Disabled  
Power LED indicates AC absent  
Alarms not Displayed When Armed  
Low Temperature Warning Disabled

ex. For Partition 1 enter section [101], for Partition 2 enter section [102] etc.

Section	Partition	Label
[101] to [108]	1 to 8	

**NOTE:** Partition 1 Label is also used as the System Label.

## [120]-[151] Command Output Labels

Default: "Command\_O/P\_1" - "Command\_O/P\_4"

For Partition 1 Command O/P 1 to 4 enter [120] to [123]

For Partition 2 Command O/P 1 to 4 enter [124] to [127]

For Partition 3 Command O/P 1 to 4 enter [128] to [131]

For Partition 4 Command O/P 1 to 4 enter [132] to [135]

For Partition 5 Command O/P 1 to 4 enter [136] to [139]

For Partition 6 Command O/P 1 to 4 enter [140] to [143]

For Partition 7 Command O/P 1 to 4 enter [144] to [147]

For Partition 8 Command O/P 1 to 4 enter [148] to [151]

Section	Part	Cmd. Output	Label
[120]-[151]	1to8	1 to 4	

## [201]-[264] Door Chime Sound Programming

You can program the keypad to make up to four different door chime sounds for individual zones.  
ex. For Zone 1 enter section [201], for Zone 2 enter section [202] etc.

Default	Option	ON	OFF
ON	1	6 Beeps	Disabled
OFF	2	"Bing-Bing" Sound	Disabled
OFF	3	"Ding-Dong" Sound	Disabled
OFF	4	Alarm Tone	Disabled
OFF	5-8	For Future Use	

[994] [★] Initiate Global Keypad Chime Broadcast

[995] [★] Reset Keypad Options to Factory Default



[996] [★] Label Default

[997] View Software Version

[998] [★] Initiate Global Label Broadcast

[999] [★] Reset Keypad EEPROM to Factory Defaults

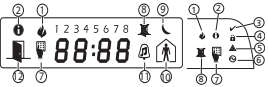
## Keypad Display Symbols

	8	Bypass — Indicates that there are zones automatically or manually bypassed.
	9	For Future Use
	10	Arm Mode — Indicates the mode the panel is armed in.
		Stay — Indicates that the panel is armed in the Stay Mode. It will turn on at the beginning of the Exit Delay
1	Fire — Indicates that there are fire alarms in memory.	
2	Memory — Indicates that there are alarms in memory.	
3	Ready Light (green) — If the Ready light is on, the system is ready for arming.	11
4	Armed Light (red) — If the Armed light is on, the system has been armed successfully.	
5	System Trouble — Indicates that a system trouble is active.	12
6	AC — Indicates that AC is present at the main panel.	
7	Program — Indicates that the system is in Installer's Programming, or the keypad is busy.	
		Open — When zones are opened, the open zones will be displayed.

## LIMITED WARRANTY

Digital Security Controls (DSC) warrants that for a period of 12 months from the date of purchase the product shall be free of defects in materials and workmanship under normal use and that in fulfillment of any breach of such warranty, DSC shall, at its option, repair or replace the defective equipment upon return of the equipment to its repair depot. This warranty applies only to defects in parts and workmanship and not to damage incurred in shipping or handling, or damage due to causes beyond the control of Digital Security Controls such as lightning, excessive voltage, mechanical shock, water damage, or damage arising out of abuse, alteration or improper application of the equipment. The foregoing warranty shall apply only to the original buyer, and is and shall be in lieu of any and all other warranties, whether expressed or implied and of all other obligations or liabilities on the part of Digital Security Controls. Digital Security Controls neither assumes responsibility for, nor authorizes any other person purporting to act on its behalf to modify or to change this warranty, nor to assume for it any other warranty or liability concerning this product. In no event shall Digital Security Controls be liable for any direct, indirect or consequential damages, loss of anticipated profits, loss of time or any other losses incurred by the buyer in connection with the purchase, installation or operation or failure of this product. **WARNING:** Digital Security Controls recommends that the entire system be completely replaced on a regular basis. However, despite frequent testing, and due to, but not limited to, criminal tampering or electrical disruption, it is possible for this product to fail to perform as expected. **IMPORTANT INFORMATION:** Changes/modifications not expressly approved by DSC could void the user's authority to operate this equipment.

**IMPORTANT - READ CAREFULLY:** DSC Software purchased with or without Products and Components is copyrighted and is purchased under the following license terms:

- This End-User License Agreement ("EULA") is a legal agreement between You (the company, individual or entity who acquired the Software and any related Hardware) and Digital Security Controls, a division of Tyco Safety Products Canada Ltd. ("DSC"), the manufacturer of the integrated security systems and the developer of the software and any related products or components ("HARDWARE") which You acquired.
- If the DSC software product ("SOFTWARE PRODUCT") or "SOFTWARE" is intended to be accompanied by HARDWARE, and is NOT accompanied by new HARDWARE, You may not use, copy or install the SOFTWARE PRODUCT. The SOFTWARE PRODUCT includes computer software, and may include associated media, printed materials, and "online" or electronic documentation.
- Any software provided along with the Software Product that is associated with a separate end-user license agreement is licensed to You under the terms of that license agreement.
- By installing, copying, downloading, storing, accessing or otherwise using the Software Product, You agree unconditionally to be bound by the terms of this EULA, even if this EULA is deemed to be a modification of any previous arrangement or contract. If You do not agree to the terms of this EULA, DSC is unwilling to license the Software Product to You, and You have no right to use it.

### SOFTWARE PRODUCT LICENSE

The SOFTWARE PRODUCT is protected by copyright laws and international copyright treaties, as well as other intellectual property laws and treaties. The SOFTWARE PRODUCT is licensed, not sold.

1. **GRANT OF LICENSE.** This EULA grants You the following rights:

- Software Installation and Use** - For each license You acquire, You may have only one copy of the SOFTWARE PRODUCT installed.
- Storage/Network Use** - The SOFTWARE PRODUCT may not be installed, accessed, displayed, run, shared or used concurrently on or from different computers, including a workstation, terminal or other digital electronic device ("Device"). In other words, if You have several

workstations, You will have to acquire a license for each workstation where the SOFTWARE PRODUCT will be used.

(b) **Backup Copy** - You may make back-up copies of the SOFTWARE PRODUCT, but You may only have one copy per license installed at any given time. You may use the back-up copy solely for archival purposes. Except as expressly provided in this EULA, You may not otherwise make copies of the SOFTWARE PRODUCT, including the printed materials accompanying the SOFTWARE.

### 2. DESCRIPTION OF OTHER RIGHTS AND LIMITATIONS

(a) **Limitations on Reverse Engineering, Decompilation and Disassembly** - You may not reverse engineer, decompile, or disassemble the SOFTWARE PRODUCT, except only to the extent that such activity is expressly permitted by applicable law notwithstanding this limitation. You may not make any changes or modifications to the Software, without the written permission of an officer of DSC. You may not remove any proprietary notices, marks or labels from the Software Product. You shall institute reasonable measures to ensure compliance with the terms and conditions of this EULA.

(b) **Separation of Components** - The Software Product is licensed as a single product. Its component parts may not be separated for use on more than one HARDWARE unit.

(c) **SOFTWARE WITH HARDWARE** - If You acquired this SOFTWARE WITH HARDWARE, then the SOFTWARE PRODUCT is licensed with the HARDWARE as a single integrated product. In this case, the SOFTWARE PRODUCT may only be used with the HARDWARE as set forth in this EULA.

(d) **Rental** - You may not rent, lease or lend the SOFTWARE PRODUCT. You may not make it available to others or post it on a server or web site.

(e) **Software Product Transfer** - You may transfer all of Your rights under this EULA only as part of a permanent sale or transfer of the HARDWARE, provided You retain no copies, You transfer all of the SOFTWARE PRODUCT (including all component parts, the media and printed materials, any upgrades and this EULA), and provided the recipient agrees to the terms of this EULA. If the SOFTWARE PRODUCT is an upgrade, any transfer must also include all prior versions of the SOFTWARE PRODUCT.

(f) **Termination** - Without prejudice to any other rights, DSC may terminate this EULA if You fail to comply with the terms and conditions of this EULA. In such event, You must destroy all copies of the SOFTWARE PRODUCT and all of its component parts.

(g) **Trademarks** - This EULA does not grant You any rights in connection with any trademarks or service marks of DSC or its suppliers.

**COPYRIGHT** - All title and intellectual property rights in and to the SOFTWARE PRODUCT (including but not limited to any images, photographs, and text incorporated into the SOFTWARE PRODUCT), the accompanying printed materials, and any copies of the SOFTWARE PRODUCT, are owned by DSC or its suppliers. You may not copy the printed materials accompanying the SOFTWARE PRODUCT. All title and intellectual property rights in and to the content which may be accessed through use of the SOFTWARE PRODUCT are the property of the respective content owner and may be protected by applicable copyright or other intellectual property laws and treaties. This EULA grants You no rights to use such content. All rights not expressly granted under this EULA are reserved by DSC and its suppliers.

**4. EXPORT RESTRICTIONS** - You agree that You will not export or re-export the SOFTWARE PRODUCT to any country, person, or entity subject to Canadian export restrictions.

**5. CHOICE OF LAW** - This Software License Agreement is governed by the laws of the Province of Ontario, Canada.

**6. ARBITRATION** - All disputes arising in connection with this Agreement shall be determined by final and binding arbitration in accordance with the Arbitration Act, and the parties agree to be bound by the

arbitrator's decision. The place of arbitration shall be Toronto, Canada, and the language of the arbitration shall be English.

## 7. LIMITED WARRANTY

(a) **NO WARRANTY** - DSC PROVIDES THE SOFTWARE "AS IS" WITHOUT WARRANTY. DSC DOES NOT WARRANT THAT THE SOFTWARE WILL MEET YOUR REQUIREMENTS OR THAT OPERATION OF THE SOFTWARE WILL BE UNINTERRUPTED OR ERROR-FREE.

(b) **CHANGES IN OPERATING ENVIRONMENT** - DSC shall not be responsible for problems caused by changes in the operating characteristics of the HARDWARE, or for problems in the interaction of the SOFTWARE PRODUCT with non-DSC SOFTWARE or HARDWARE PRODUCTS.

(c) **LIMITATION OF LIABILITY; WARRANTY REFLECTS ALLOCATION OF RISK** - IN ANY EVENT, IF ANY STATUTE IMPLIES WARRANTIES OR CONDITIONS NOT STATED IN THIS LICENSE AGREEMENT, DSC'S ENTIRE LIABILITY UNDER ANY PROVISION OF THIS LICENSE AGREEMENT SHALL BE LIMITED TO THE GREATER OF THE AMOUNT ACTUALLY PAID BY YOU TO LICENSE THE SOFTWARE PRODUCT AND FIVE CANADIAN DOLLARS (CAD\$5.00). BECAUSE SOME JURISDICTIONS DO NOT ALLOW THE EXCLUSION OR LIMITATION OF LIABILITY FOR CONSEQUENTIAL OR INCIDENTAL DAMAGES, THE ABOVE LIMITATION MAY NOT APPLY TO YOU.

(d) **DISCLAIMER OF WARRANTIES** - THIS WARRANTY CONTAINS THE ENTIRE WARRANTY AND SHALL BE IN LIEU OF ANY AND ALL OTHER WARRANTIES, WHETHER EXPRESSED OR IMPLIED (INCLUDING ALL IMPLIED WARRANTIES OF MERCHANTABILITY OR FITNESS FOR A PARTICULAR PURPOSE) AND OF ALL OTHER OBLIGATIONS OR LIABILITIES ON THE PART OF DSC. DSC MAKES NO OTHER WARRANTIES. DSC NEITHER ASSUMES NOR AUTHORIZES ANY OTHER PERSON PURPORTING TO ACT ON ITS BEHALF TO MODIFY OR TO CHANGE THIS WARRANTY, NOR TO ASSUME FOR IT ANY OTHER WARRANTY OR LIABILITY CONCERNING THIS SOFTWARE PRODUCT.

(e) **EXCLUSIVE REMEDY AND LIMITATION OF WARRANTY** - UNDER NO CIRCUMSTANCES SHALL DSC BE LIABLE FOR ANY SPECIAL, INCIDENTAL, CONSEQUENTIAL OR INDIRECT DAMAGES BASED UPON BREACH OF WARRANTY, BREACH OF CONTRACT, NEGLIGENCE, STRICT LIABILITY OR ANY OTHER LEGAL THEORY. SUCH DAMAGES INCLUDE, BUT ARE NOT LIMITED TO, LOSS OF PROFITS, LOSS OF THE SOFTWARE PRODUCT OR ANY ASSOCIATED EQUIPMENT, COST OF CAPITAL, COST OF SUBSTITUTE OR REPLACEMENT EQUIPMENT, FACILITIES OR SERVICES, DOWNTIME, PURCHASERS TIME, THE CLAIMS OF THIRD PARTIES, INCLUDING CUSTOMERS, AND INJURY TO PROPERTY. **WARNING:** DSC recommends that the entire system be completely tested on a regular basis. However, despite frequent testing, and due to, but not limited to, criminal tampering or electrical disruption, it is possible for this SOFTWARE PRODUCT to fail to perform as expected.

The trademarks, logos, and service marks displayed on this document are registered in the United States [or other countries]. Any misuse of the trademarks is strictly prohibited and Tyco International Ltd. will aggressively enforce its intellectual property rights to the fullest extent of the law, including pursuit of criminal prosecution wherever necessary. All trademarks not owned by Tyco International Ltd. are the property of their respective owners, and are used with permission or allowed under applicable laws.

Product offerings and specifications are subject to change without notice. Actual products may vary from photos. Not all products include all features. Availability varies by region; contact your sales representative.



Words Table/ 字一览表

Item #	Text/ 字	Item #	Text/ 字	Item #	Text/ 字	Item #	Text/ 字	Item #	Text/ 字	Item #	Text/ 字	Item #	Text/ 字	Item #	Text/ 字	Item #	Text/ 字
001	Aborted	028	Bypass	055	Downstairs	082	Gallery	109	Light	136	Panic	163	Service	190	West	217	O
002	AC	029	Bypassed	056	Drawer	083	Garage	110	Lights	137	Partition	164	Shed	191	Window	218	P
003	Access	030	Cabinet	057	Driveway	084	Gas	111	Living	138	Patio	165	Shock	192	Zone	219	Q
004	Active	031	Cancelled	058	Duct	085	Glass	112	Load	139	Pet	166	Shop	193	0	220	R
005	Activity	032	Car	059	Duress	086	Goodbye	113	Loading	140	Phone	167	Side	194	1	221	S
006	Alarm	033	Carbon	060	East	087	Gym	114	Low	141	Please	168	Siren	195	2	222	T
007	All	034	Central	061	Energy	088	Hallway	115	Lower	142	PM	169	Sliding	196	3	223	U
008	AM	035	Chime	062	Enter	089	Heat	116	Main	143	Police	170	Smoke	197	4	224	V
009	Area	036	Closed	063	Entry	090	Hello	117	Master	144	Pool	171	Son's	198	5	225	W
010	Arm	037	Closet	064	Error	091	Help	118	Mat	145	Porch	172	Sound	199	6	226	X
011	Armed	038	Closing	065	Exercise	092	High	119	Medical	146	Power	173	South	200	7	227	Y
012	Arming	039	Code	066	Exit	093	Home	120	Memory	147	Press	174	Special	201	8	228	Z
013	Attic	040	Communicator	067	Exterior	094	House	121	Menu	148	Program	175	Stairs	202	9	229	(Space)
014	Auxiliary	041	Computer	068	Factory	095	In	122	Monoxide	149	Progress	176	Stay	203	A	230	' (Apostrophe)
015	Away	042	Control	069	Failure	096	Install	123	Mother's	150	Quiet	177	Sun	204	B	231	- (Dash)
016	Baby	043	Date	070	Family	097	Interior	124	Motion	151	Rear	178	Supervisory	205	C	232	_ (Underscore)
017	Back	044	Daughter's	071	Father's	098	Intrusion	125	No	152	Receiver	179	System	206	D	233	*
018	Bar	045	Degrees	072	Feature	099	Invalid	126	North	153	Report	180	Tamper	207	E	234	#
019	Basement	046	Delay	073	Fence	100	Is	127	Not	154	RF	181	Temperature	208	F	235	:
020	Bathroom	047	Den	074	Fire	101	Key	128	Now	155	Right	182	Test	209	G	236	/
021	Battery	048	Desk	075	First	102	Kids	129	Number	156	Room	183	Time	210	H	237	?
022	Bedroom	049	Detector	076	Floor	103	Kitchen	130	Off	157	Safe	184	To	211	I		
023	Bonus	050	Dining	077	Force	104	Latchkey	131	Office	158	Saver	185	Touchpad	212	J		
024	Bottom	051	Disarmed	078	Foyer	105	Laundry	132	OK	159	Schedule	186	Trouble	213	K		
025	Breezeway	052	Door	079	Freeze	106	Left	133	On	160	Screen	187	Unbypass	214	L		
026	Building	053	Down	080	Front	107	Level	134	Open	161	Second	188	Unit	215	M		
027	Bus	054	Download	081	Furnace	108	Library	135	Opening	162	Sensor	189	Up	216	N		

# 安装说明

PK5500 键盘可以在最多 64 个防区的报警控制主机上使用。这些键盘兼容如下 DSC 安防系统的最新版本：

- PC580 • PC585 • PC1555MX • PC1565 • PC5020
- PC1616 • PC1832 • PC1864 • PC5005
- PC5008 • PC5010 • PC5015 • PC5016

## 规格

- 温度范围：-10°C 至 +55°C (14°F 至 131°F)
- 湿度（最大值）：93% R.H., 无冷凝
- 塑料外壳保护等级：IP30, IK04
- 额定电压：额定 12VDC
- 通过 4 路通信总线连接到控制主机
- 一个键盘防区输入 /PGM 输出 \*
- 电流消耗：50mA (待机) /125mA (最大)
- 壁挂式防拆装置
- 5 个可编程功能键
- 就绪 (绿色 LED)、设防 (红色 LED)、故障 (黄色 LED)、AC (绿色 LED)
- 低温传感器：报警 6°C (43°F)/ 恢复 9°C (48°F)
- \*备注：请勿将防区编程设定为火警类型或全天候型。

## 打开包装

Power 键盘包装箱中包括以下部件：

- 一个 Power 键盘 • 键盘内门标签
- 四个安装螺钉 • 一个防拆开关
- 两个线束电阻 • 一份安装说明

## 安装

您应将键盘安装在指定入口和出口的附近。请选择干燥安全的位置并按照下述步骤安装键盘。

## 拆卸键盘

1. 用平口螺丝起插入两个槽沟中的一个。
2. 如下图所示，将螺丝起向背板塑胶方向旋转，这将松开前部面板的一侧。
3. 对另一个槽沟重复步骤 1 和 2，完全分开前部面板，开始接线。

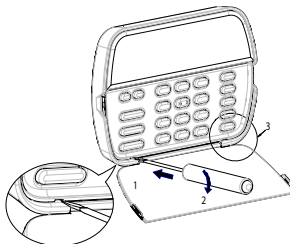

## 安装键盘和布线

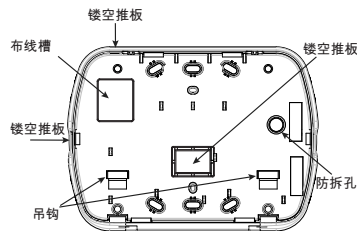

1. 使用安装孔将键盘固定到墙上。除非在单组盒上安装，否则使用提供的全套 4 个螺丝钉。
2. 从吊钩上卸下键盘。把键盘放到底盘中，务必尽可能把电线推回墙内。将电线引到键盘内，确保避开较高的组件。吧嗒一声关上前部组件，确保下面的电线没有挤压到键盘。
3. 将键盘放到底盘上的吊钩中，并向下旋转以啮合。
4. 通过布线槽或镂空推板布线。将 Keybus 和 PGM/Zone 配线连接到键盘。把防拆器放到底盘上的防拆孔中。

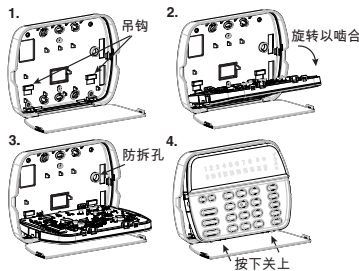

**注意：**如果前部键盘组件之间存在压力，请打开键盘，重新布线并再次关上前部键盘组件。重复执行上述步骤，直到键盘正确关闭。

## 连线

1. 装置连线前，确保断开控制主机上的所有电源（交流变压器和电池）。
2. 将四根通信总线（红、黑、黄、绿）从控制主机连接到键盘终端。见图：

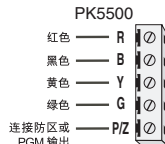

3. 如果“P/Z”端口编程设定为输入口，可以给键盘的“P/Z”端口连接就近的门触点之类的装置。这样就不需要重新将信号线连接到控制主机。要连接防区，请将信号线的一端从探测器连接到“P/Z”端口，将另一条线连接到 B(黑色)端口。对于有源设备，将红色电线连接到 R(正极)端口，黑色电线连接到 B(负极)端口。使用末端电阻监控时，按《系统安装手册》中介绍的配置之一连接防区。
4. 如果“P/Z”终端被编程为输出口，则按区间 [080] 中的 PGM 编程输出。电源电压正极和“P/Z”端口之间可以连接小型继电器、蜂鸣器或其他 DC 装置（最大负荷 50mA）。

步骤 4 - 按 [#] 退出。

默认值：003 | | | (有效的输入是 000-255, 000 = 信息显示不限) 这个编号代表信息出现并超时之后，按任意键清除已下载信息的次数。

## [074] 按键选项

默认值	选项	开	关
ON	<input type="checkbox"/>	1 [F] 火警键启用	[F] 火警键禁用
ON	<input type="checkbox"/>	2 [A] 辅助键启用	[A] 辅助键禁用
ON	<input type="checkbox"/>	3 [P] 应急键启用	[P] 应急键禁用
OFF	<input type="checkbox"/>	4-8 备用	

## [076] 第一个键盘选项

默认值	选项	开	关
ON	<input type="checkbox"/>	1 编程时显示代码	编程时显示“K”
ON	<input type="checkbox"/>	2 启用本地时钟显示	禁用本地时钟显示
OFF	<input type="checkbox"/>	3 本地时钟显示 24 小时时间	时钟显示 AM/PM
ON	<input type="checkbox"/>	4 启用自动警报内存滚动	禁用自动警报内存滚动
OFF	<input type="checkbox"/>	5 本地温度显示	本地温度显示
ON	<input type="checkbox"/>	6 启用旁路选项提示	禁用旁路选项提示
OFF	<input type="checkbox"/>	7 备用	
OFF	<input type="checkbox"/>	8 启用自动滚动开放区域	禁用自动滚动开放区域

## [077] 第二个键盘选项

默认值	选项	开	关
ON	<input type="checkbox"/>	1 防区打开时启用门铃	防区打开时禁用门铃
ON	<input type="checkbox"/>	2 防区恢复时启用门铃	防区恢复时禁用门铃
OFF	<input type="checkbox"/>	3 第 5 终端是键盘 PGM 输出	第 5 终端是键盘防区输入
OFF	<input type="checkbox"/>	4 启用选择语言	禁用选择语言
OFF	<input type="checkbox"/>	5 启用 Power LED	禁用 Power LED
ON	<input type="checkbox"/>	6 Power LED 显示有 AC 电源	Power LED 显示无 AC 电源
ON	<input type="checkbox"/>	7 设防时始终显示警报	设防时不显示警报
OFF	<input type="checkbox"/>	8 启用低温警告	禁用低温警告

备注：低温报警在 6°C (43°F) 触发，在 9°C (48°F) 恢复。

## [080] PGM 终端 1

默认值：01 ☐ 1-14 PGM 可编程输出跟随，15 本地 PGM 可编程输出脉冲，16 本地 PGM 可编程输出触发器。

## [082] 本地 PGM 可编程输出脉冲激活时间

默认值：00 ☐ 分钟（有效范围 00-99）

默认值：05 ☐ 秒（有效范围 00-99）

## [101]-[108] 分区标签

例如：对分区 1，输入区段 [101]，对分区 2，输入区段 [102]，依此类推。

区段	分区	标签
[101]-[108]	1-8	

备注：分区 1 标签也用作系统标签。

## [120]-[151] 命令输出标签

默认值：“Command\_O/P\_1” - “Command\_O/P\_4”

对于分区 1 命令 O/P 1 到 4，输入 [120] 到 [123] 对于分区 5 命令 O/P 1 到 4，输入 [136] 到 [139]  
对于分区 2 命令 O/P 1 到 4，输入 [124] 到 [127] 对于分区 6 命令 O/P 1 到 4，输入 [140] 到 [143]  
对于分区 3 命令 O/P 1 到 4，输入 [128] 到 [131] 对于分区 7 命令 O/P 1 到 4，输入 [144] 到 [147]  
对于分区 4 命令 O/P 1 到 4，输入 [132] 到 [135] 对于分区 8 命令 O/P 1 到 4，输入 [148] 到 [151]

区段	分区	命令输出	标签
[120]-[151]	1-8	1-4	

## [201]-[264] 门类型编程

您可以对键盘编程，以便为具体防区设置四种不同的门铃声。例如，对防区 1，输入区段 [201]，对防区 2，输入 [202]，依此类推。

默认值	选项	开	关
ON	<input type="checkbox"/>	1 6 次蜂鸣声	禁用
OFF	<input type="checkbox"/>	2 “乒-乒”声	禁用
OFF	<input type="checkbox"/>	3 “叮-咚”声	禁用
OFF	<input type="checkbox"/>	4 警报声	禁用
OFF	<input type="checkbox"/>	5-8 备用	

## [994]\* 启动全局键盘门铃广播

## [995]\* 将键盘选项重置为出厂默认值

## [996]\* 标签默认值

## [997] 查看软件版本

## [998]\* 启动全局标签广播

## [999]\* 将 LCD EEPROM 重置为出厂默认值

## 键盘显示符号

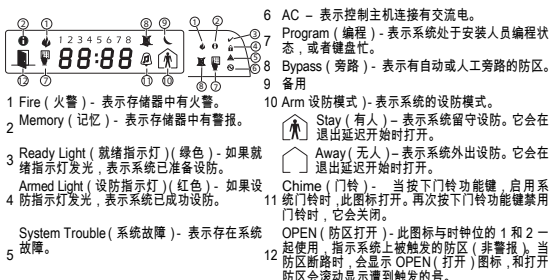

6 AC - 表示控制主机连接有交流电。  
7 Program (编程) - 表示系统处于安装人员编程状态，或者键盘忙。  
8 Bypass (旁路) - 表示有自动或人工旁路的防区。  
9 备用。  
10 Arm 设防模式 - 表示系统的设防模式。  
Stay (有人) - 表示系统留守设防。它会在退出延迟开始时打开。  
Away (无人) - 表示系统外出设防。它会在退出延迟开始时打开。  
Chime (门铃) - 当按下门铃功能键，启用系统门铃时，此图标打开。再次按下门铃功能键禁用门铃时，它会关闭。  
OPEN (防区打开) - 此图标与时钟位的 1 和 2 一起使用，指示系统上被触发的防区（非警报）。当防区断路时，会显示 OPEN (打开) 图标，和打开防区会滚动显示遭到触发的号。

[illegible]

[illegible]

## 有限担保

Digital Security Controls (DSC) 担保, 在购买产品后的 12 个月内, 产品在正常使用情况下不会存在材料和制造问题; 若出现问题或 Digital Security Controls 将在修理地收到退还的设备时选择修理或更换故障设备。此担保仅适用于零部件和制造缺陷, 不适用于运输或搬运途中导致的损坏或在 Digital Security Controls 无法控制的条件下导致的损坏, 例如闪电、过电压、机械冲击、水损损坏, 也不适用于因滥用、改变或不正确使用设备而导致的损坏。

上述担保仅适用于原买家, 并将取代所有其他明示或暗示的担保。除此之外, DSC 不承担任何其他义务或责任。DSC 不承担也不授权任何其他方代表其承担修改或改变本担保的责任, 也不承担关于本产品的任何其他担保或责任。在任何情况下, Digital Security Controls 均不承担买方在购买、安装、操作或不能操作本产品而导致的任何直接、间接或后果性损失、预期利润损失、时间损失或其他损失。

**警告:** 尽管频繁测试, 由于罪犯行为破坏或电力中断等原因, 本品仍有可能无法发挥应有的效果。

**重要信息:** 在未经 Digital Security Controls 明确许可的情况下进行修改或更改会导致用户操作本设备的权利失效。

**重要 - 请仔细阅读: 无论是单独购买, 还是产品和部件附带的 DSC 软件, 其版权都有归属, 对其购买要遵循以下条款:**

- 该最终用户许可协议 (“EULA”) 是您 (已获取该软件和相关硬件的公司、个人和团体) 和加拿大泰科安全设备有限公司分公司 —— 数码保安控制公司 (“DSC”) 之间的法律协议。该公司是集成安防系统的制造商, 也是您已获取的该软件和相关硬件或部件的开发商。

- 如果 DSC 软件产品 (“软件产品” 或 “软件”) 和硬件绑定销售, 但 **没有** 和新硬件绑定, 那么您不能使用、拷贝或安装软件产品。软件产品包括计算机软件, 可能还有相关多媒体、印刷资料或在线或电子文档。

- 提供与另外最终用户许可协议相关的软件产品时附带的任何软件按照该许可协议的条款对您实行授权。

- 一旦安装、复制、下载、储存、访问或使用了软件产品, 您将无条件同意接受本 EULA 条款, 即使本 EULA 被视为是先前协议或合约的修订。如果您不同意该 EULA 中条款, DSC 则不能将 SOFTWARE PRODUCT 授权给您, 您则无权使用它。

### 软件产品许可

本软件产品受版权法, 国际版权条约和其他相关知识产权法和条款保护。本软件仅授权使用, 非出售。

#### 1. 协议授予: 本 EULA 授予您以下权利:

(a) **软件安装与使用** 对于您获得的每个许可, 您可以安装仅一份软件产品拷贝。

(b) **存储/网络应用** 不能同时在或从不同计算机中安装、访问、显示、运行、共享或使用该软件产品, 包括工作站、终端、或其他数字电子设备。换言之之, 如果您有几个工作站, 那么你必须为每个要应用该软件的工作站获取一个许可证。

(c) **备份拷贝** 您可以多次备份拷贝该软件产品。但是在给定时间仅允许安装每个许可的一份拷贝。备份拷贝仅用于存档。除在本协议中明确说明, 否则不得再复制本软件产品, 包括其印刷品。

#### 2. 其他权利和限制说明:

(a) **反向工程、反编译、反汇编限制** 除非或仅在法律明确准许范围之内 (尽管有此限制), 否则您不能对本软件实施反向工程、反编译或反汇编。未经 DSC 官方书面允许, 您不能改变或修改该软件, 不能从软件删除任何专有标记、商标或标志。您要采取合理措施来确保符合 EULA 的条款和条件。

(b) **组件拆分** 本软件产品作为独立的产品进行授权。它的组件不能被拆分、并用于一个以上的硬件单元。

(c) **单一集成产品** 如果您在购买硬件的情况下获取本软件, 那么软件产品和硬件作为一个独立的集成产品被授权。在这种情况下, 正如 EULA 阐述一样, 仅在使用硬件时才能使用软件产品。

(d) **转售** 不得出租, 租赁或出借本软件产品。也不得转于他人使用, 或在服务器或网站上发布。

(e) **软件转让** 如果您没有保留任何拷贝并且您要转让全部软件产品 (包括部件、多媒体和印刷材料、任何升级版本和该 EULA), 如果接收者同意 EULA 中条款, 那么您可以将您所有 EULA 授予的权利仅作为永久销售的一部分转让或将硬件转让。如果本软件产品是旧版本的更新, 转让必须包含所有旧版软件产品。

(f) **终止协议** 如果您违反了 EULA 条款和条件, DSC 在不伤害您其他权利的情况下终止该 EULA。在这种情况下, 您必须销毁所有软件产品拷贝及其所有部件。

(g) **商标** 本协议并未授权您使用任何 DSC 商标权或其供应商的商标权。

3. **版权:** 本软件产品、附带印刷材料及软件拷贝中的所有所有权和知识产权 (包括但不限于软件中的图片、照片和文字) 归 DSC 或其供应商所有。不得复制附带的印刷材料。通过使用该软件产品而获悉的某些内容的所有权和知识产权属于这些内容的拥有者, 并受版权或其他知识产权法律和条约保护。EULA 没有授权您使用这些内容。EULA 没有明确授予的所有权利归 DSC 及其供应商所有。

4. **出口限制:** 不得将本软件产品出口或转出口到任何受加拿大出口限制的国家, 个人或团体。

5. **法律管辖:** 本软件许可协议受加拿大安大略省法律管辖。

6. **仲裁:** 由本协议引发的所有争议将根据仲裁法案进行仲裁。仲裁是终局的, 对双方均有约束力。双方都要服从仲裁决定。仲裁地点应在加拿大, 多伦多, 仲裁语言应为英语。

#### 7. 有限担保:

(a) **免除担保** DSC 只 “按原样” 提供软件本身, 并不作其他方面的担保。DSC 不会保证该软件能满足您的需要、其运行无故障、无错误。

(b) **改变运行环境** 针对因硬件操作环境改变或与非 DSC 软硬件产品进行交互引起的问题, DSC 不负责任。

(c) **赔偿责任限制; 保证中的风险分配** 在任何情况下, 如果任何法令包含了该许可协议中没有阐述的担保或条件, 根据该许可协议条款, DSC 的全部责任局限于在您为该软件产品的许可协议实际支付的数额和 5 加元 (CAD\$5.00) 中选择较大的数额作为赔偿。因为有些司法管辖区不允许排除或限制间接或意外损失, 所以上述限制可能对您不适用。

(d) **免责声明** 本担保涵盖完整的担保条款, 并取代任何及所有其他担保, 无论是明示还是暗示 (包括适销性和特定适宜性的所有暗示保证), 也取代 DSC 的所有其他责任或义务。DSC 不承诺其他担保, 不委托或授权他人修改或改变该担保, 不承担关于该软件产品的其他担保和责任。

(e) **免除赔偿和担保限制** 在任何情况下, 针对因违反该担保、协议、或因法律疏忽和严重错误, 或以其他法律理论为基础而产生的任何特殊的、意外的、继发的或间接的损坏, DSC 不承担任何责任。这种损害包括, 但不仅限于, 利润损失, 软件产品或任何相关的设备损坏, 资金成本, 替代或更换设备的费用, 设施或服务, 停机时间, 购买时间, 包括客户的第三方索赔和财产损失。

**警告:** DSC 推荐对整个系统定期进行安全检测, 但是, 即使频繁检测, 因为 (但不限于) 于非法入侵、电子干扰或其他原因, 本软件产品仍有可能运行不正常。

本手册中所包含的商标、标识、服务标记已在美国【或其他国家】注册。严禁任何不当使用, 如有违反, Tyco International Ltd. 将在法律许可的最大范围内积极保护其知识产权, 包括诉诸刑事法律。Tyco International Ltd. 所有的商标是其各自所有者的财产, 须经许可使用或适用法律允许方可使用。

产品和技术规格如有变更, 恕不另行通知。实际产品可能与照片有所不同。并非所有的产品会包括所有功能, 会因地区而异, 具体请联系您的销售代表。